



**NEW**

STR-9 COMBAT X  
PISTOL Page 35

**5YEAR**  
WARRANTY



## 2024 DEALER WORKBOOK

## CONTENTS

<b>NEW</b> 2 Introduction	<b>NEW</b> 15 Model 3000 Sporting	<b>NEW</b> 28 STR-45	<b>NEW</b> 38 F. S. Defense & 3-Gun
4 M-Series Introduction	16 Model 3000 R	<b>NEW</b> 29 STR-9 Mid Size	40 Defense Line
6 Model 3500	16 M3K 3-Gun	30 STR Micro Compact	42 Double Defense
8 M3500 Snow Goose F.S.	<b>NEW</b> 18 Model 3020	31 STR Sub-Compact	44 Condor
<b>NEW</b> 10 M3500 Waterfowl	20 M3020 Upland Special	32 STR Compact	46 Condor Outback
<b>NEW</b> 10 M3500 Predator/Turkey	22 P3500 Pump	<b>NEW</b> 33 STR Mid-Size	46 Condor Competition
<b>NEW</b> 12 Model 3000	24 P3000 Pump	<b>NEW</b> 34 STR Full Size	48 The Grand
<b>NEW</b> 13 Model 3000 Compact	<b>NEW</b> 26 STR-Series Introduction	<b>NEW</b> 35 STR Combat	50 Uplander
<b>NEW</b> 14 Model 3000	<b>NEW</b> 28 STR Full Size	36 P3000 F. S. Supreme	52 Coach Guns
			<b>NEW</b> 54 Gear & Accessories
			58 Price List



### STOEGER IS...

For a century we are world-renowned for offering firearms that are extremely accurate, incredibly rugged and unwaveringly reliable at a reasonable price. In 2024, we are highlighting that legacy with our all-new M3000 Signature shotgun that elevates the looks but maintains its tough-as-nails build. In addition, we've expanded our STR series with exciting color additions throughout the line, an extreme-duty Combat X version, and caliber expansions. Be it hunting, target shooting, competition, or personal protection, Stoeger has a firearm that meets your needs, and we hope you'll join us on another 100 years of success.



**NEW** M-SERIES HUNTING SHOTGUNS — PAGES 4-21

#### Your Stoeger firearm is backed by a 5-Year Warranty.

A 5-Year Warranty guarantees that if anything should go wrong, under normal use, your firearm will be serviced for you by skilled gunsmiths at our national firearm service center. While your Stoeger is under warranty, we will assume the cost of parts, labor and shipping required to get your firearm back to you and working perfectly.



# M-SERIES SEMI-AUTO SHOTGUNS

Great Got Even Better

## Model 3500



**MODEL 3500 – 12-GA, 3½"**  
ITEM # 36024 Black synthetic

## Model 3000



**MODEL 3000 – 12-GA, 3"**  
ITEM # 36016 Black synthetic

## Where Innovation and Superb Performance Meet

Armed with ideas and suggestions from experienced hunters and shooters, Stoeger turned its innovative engineers loose with a lofty assignment: turn an already great Stoeger shotgun platform into an excellent birdslaying, clays-smashing machine. They succeeded, and the M-Series is the result. These guns have super-sleek profiles, thanks to enhanced ergonomics that make them shoulder and point instinctively. Larger bolt handles, bolt-release buttons and safeties make for easier operation in cold weather when wearing gloves. Beveled ports make fast reloads a snap. Thinner grip areas and redesigned forends ensure a firm grip and positive control in any weather. Removable cheek pieces make shooting more comfortable, and improved recoil pads team with the proven Inertia Driven® system to soak up felt recoil when shooting even the stoutest loads. If you're ready to step up your shooting experience without emptying your bank account, pick up a Stoeger M-Series shotgun today.

## Model 3020



**MODEL 3020 – 12-GA, 3"**  
ITEM # 36007 Black synthetic



**INERTIA DRIVEN**

### INERTIA DRIVEN® SYSTEM

The Inertia Driven® system used in the Model 3000, Model 3500 and Model 3020 is superior to any other operating system. The rotating bolt head ensures a positive steel-to-steel lockup that provides Stoeger semi-autos with superior strength and reliability.

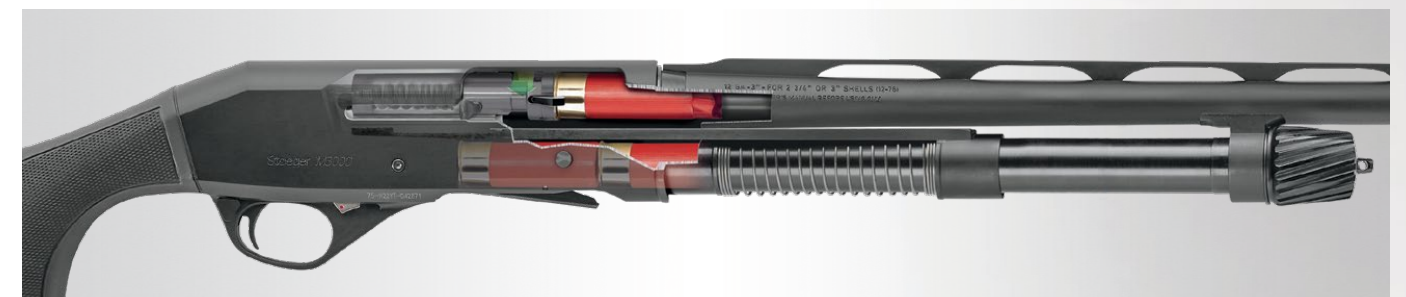
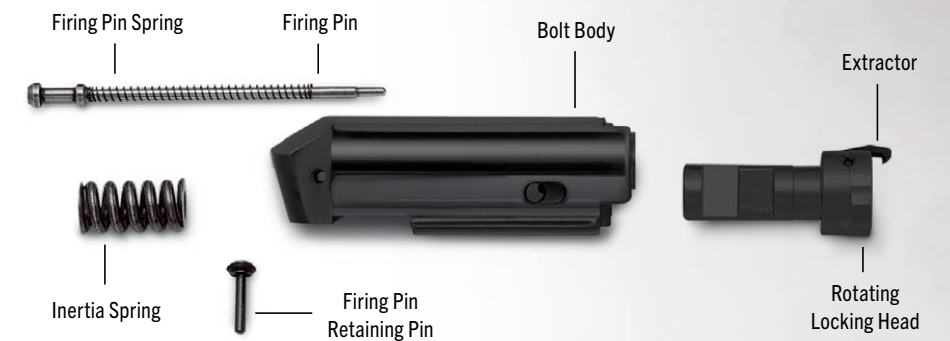

Near the end of the recoil cycle, chamber pressure drops to a safe level and the gun's rearward motion slows. The heavy inertia spring then thrusts the bolt assembly rearward, unlocking the rotating bolt head, extracting the spent shell from the chamber, and pulling it against the ejector.

## Model 3500

Magnum performance and reliability



**MODEL 3500 – 12-GA, 3½"**  
ITEM # 36054 Realtree® Max-7™



**MODEL 3500 – 12-GA, 3½"**  
ITEM # 36049 Realtree® Max-7™, Cerakote Burnt Bronze



Stoeger's Inertia Driven® Model 3500 is chambered for 3½-inch Magnum shells, but also cycles 2¾- and 3-inch shells equally well without adjustment, providing versatility at an affordable price.

The Model 3500 is drilled and tapped to accommodate Weaver-style scope bases.



The Model 3500 comes with a recoil reducer that is a standard item with purchase. The buttstock incorporates a cut cavity that facilitates easy installation of the recoil reducer.



**MODEL 3500 – 12-GA, 3½"**  
ITEM # 36005 Mossy Oak® Bottomland™



A shim kit is included with the Model 3500, which allows you to adjust the fit of the gun for drop and cast.

The Model 3500 comes with four choke tubes (IC, M, F, XFT) that run from improved cylinder to extra-full turkey.



**MODEL 3500 – 12-GA, 3½"**  
ITEM # 36009 Black synthetic

### STANDARD FEATURES

- CHOKE TUBES:** IC, M, F, XFT and wrench.
- FINISHES:** Realtree® Max-7™, Black synthetic, Mossy Oak® Bottomland™ or Max-7™/Cerakote Burnt Bronze.
- SIGHTS:** Red-bar front sight.
- RECOIL REDUCER** (Does NOT fit M3500 with wood buttstock)
- SHIM KIT**

### OPTIONAL FEATURES

- BARRELS:** Variety of lengths and finishes.
- STOCKS:** SteadyGrip™ and standard field stock.
- WEAVER SCOPE BASE**

### MODEL 3500

ITEM NUMBER	BARREL LENGTH	STOCK	OVERALL LENGTH	AVERAGE WEIGHT	MSRP
<b>12-GAUGE 2¾", 3" AND 3½"</b>					
36009	26"	Black synthetic	48"	7.65 lbs.	\$699
36024	28"	Black synthetic	50"	7.80 lbs.	\$699
36005	28"	Mossy Oak® Bottomland™	50"	7.80 lbs.	\$799
36035	26"	Realtree® Max-7™	48"	7.65 lbs.	\$799
36054	28"	Realtree® Max-7™	50"	7.80 lbs.	\$799
36049	28"	Max-7™/Burnt Bronze	50"	7.80 lbs.	\$849

**COMMON SPECIFICATIONS:** Magazine Capacity: 4+1 Chokes: IC,M,F,XFT Type of Sights: Red-bar Length of Pull: 14¾" Drop at Heel: 2½" Drop at Comb: 1½" Minimum recommended load: 3-dram, 1½ ounce. Receiver drilled and tapped for scope mounting.

The bolt assembly of the Model 3500 includes an inertia spring and rotating locking head, two features that distinguish the bolt as an integral part of an Inertia Driven® System.



**M3500 Snow Goose**  
A blizzard of bird-slaying features



*Freedom*  
SERIES

Stoeger's Freedom Series Snow Goose shotgun combines the solid operating system of the M3500 with select U.S.-manufactured components. The result is the outstanding, all-weather, extended-capacity M3500 Snow Goose shotgun in a 922R-compliant performance configuration.



**MODEL 3500 SNOW GOOSE – 12-GA, 3½"**  
ITEM # 36014FS Distressed White Cerakote

Built on the foundation of Stoeger's rugged and reliable Inertia Driven® Model 3500 Waterfowl Special shotgun, the Snow Goose is optimized for high-volume shooting in extreme weather. Oversized controls aid operation with gloved hands. The easy-to-see front sight stands out in low light. Distressed-white weather-resistant Cerakote finish blends in with winter environments. Chambered for 3½-inch magnum shells, it cycles 2¾- and 3-inch shells equally well, and a 10+1 capacity helps you engage big flocks and shoot more between reloads. Comes with five chokes and a paracord sling.



A rugged paracord sling is included with the M3500 Snow Goose shotgun.

**STANDARD FEATURES**

**EXTENDED CHOKE TUBES:** IC, M, XFT, Close-Range, Mid-Range and wrench.

**FINISH:** Distressed White Cerakote.

**SIGHTS:** Red-bar front sight.

**OVER-SIZED BOLT HANDLE AND RELEASE**

**RECOIL REDUCER**

**SHIM KIT**

**BLACK PARACORD SLING**

**OPTIONAL FEATURES**

**BARRELS:** Variety of lengths and finishes.

**STOCKS:** SteadyGrip™ and standard field stock.

**WEAVER SCOPE BASE**

**MODEL 3500 SNOW GOOSE**

ITEM NUMBER	BARREL LENGTH	STOCK	OVERALL LENGTH	AVERAGE WEIGHT	MSRP
<b>12-GAUGE 2¾", 3" AND 3½"</b>					
36014FS	28"	Distressed White Cerakote	50"	8.20 lbs.	\$979

COMMON SPECIFICATIONS: **Magazine Capacity:** 10+1 **Extended Chokes:** IC, M, XFT, Close-Range, Mid-Range **Type of Sights:** Red-bar **Length of Pull:** 14½" **Drop at Heel:** 2½" **Drop at Comb:** 1½" **Minimum recommended load:** 3-dram, 1¼-ounce. Receiver drilled and tapped for scope mounting.

SPECIFICATIONS AND PRICES SUBJECT TO CHANGE WITHOUT NOTICE.



Loading, unloading and operating the Model 3500 Snow Goose in cold weather is made easier by the large bolt handle and bolt-release button.

The Model 3500 bolt assembly includes an inertia spring and rotating locking head, two features that distinguish the bolt as an integral part of our proven Inertia Driven® System.



## M3500 Waterfowl Special

For hardcore hunters in any weather



**MODEL 3500 WATERFOWL SPECIAL – 12-GA, 3½"**  
ITEM # 36000 Realtree® Max-7™, Cerakote Flat Dark Earth

**STANDARD FEATURES**

**EXTENDED CHOKE TUBES:** IC, M, XFT, Close-Range, Mid-Range and wrench.

**FINISH:** Realtree® Max-7™/Cerakote Flat Dark Earth.

**SIGHTS:** Fiber-optic front sight.

**OVERSIZED BOLT HANDLE AND RELEASE**

**RECOIL REDUCER**

**SHIM KIT**

**PARACORD SLING**

**OPTIONAL FEATURES**

**BARRELS:** Variety of lengths and finishes.

**STOCKS:** SteadyGrip™ and standard field stock.

**WEAVER SCOPE BASE**

**MODEL 3500 WATERFOWL SPECIAL**

ITEM NUMBER	BARREL LENGTH	STOCK	OVERALL LENGTH	AVERAGE WEIGHT	MSRP
<b>12-GAUGE 2¾", 3" AND 3½"</b>					
36000	28"	Realtree® Max-7™	50"	7.80 lbs.	\$899

COMMON SPECIFICATIONS: Magazine Capacity: 4+1 Extended Chokes: IC, M, XFT, Close-Range, Mid-Range Type of Sights: Red-bar Length of Pull: 14¾" Drop at Heel: 2½" Drop at Comb: 1½" Minimum recommended load: 3-dram, 1¼-ounce. Receiver drilled and tapped for scope mounting.

SPECIFICATIONS AND PRICES SUBJECT TO CHANGE WITHOUT NOTICE.

The M3500 Waterfowl Special includes a rugged paracord sling.



Stoeger's Inertia Driven® Model 3500 Waterfowl Special is equipped with features dedicated duck and goose hunters will appreciate. Oversized controls aid operation with gloved hands. A specially engineered loading port makes loading shells in cold weather easy. Rugged, weather-resistant construction and finish stand up to the worst conditions. The easy-to-see front sight stands out in low light. This semi-automatic shotgun is chambered for 3½-inch magnum shells, but cycles 2¾- and 3-inch shells equally well without adjustment, and five chokes are included to deliver the kind of reliable versatility and value only Stoeger can provide.



Loading, unloading and operating the Model 3500 in cold weather is made easier by the large bolt handle and bolt-release button. A specially machined and beveled loading port makes feeding shells into the magazine tube with gloved hands quick and efficient.

## M3500 Predator/Turkey

A specialty hunting firearm



**NEW**

**MODEL 3500 PREDATOR/TURKEY SPECIAL – 12-GA, 3.5"**  
ITEM # 36037 Mossy Oak® Overwatch™

For 2024, Stoeger takes its proven M3500 semi-auto platform from the duck blinds to the woods and field edges with the new M3500 Predator/Turkey. Chambered in 3.5-inch 12-ga. and powered by Stoeger's Inertia Driven® system to ensure reliable cycling of even the heaviest Magnum turkey and buckshot loads, the M3500 Predator/Turkey features a vertical grip, Mossy Oak® Overwatch™ camo finish, and the receiver is tapped for optic mounting.

**STANDARD FEATURES**

**MOJO EXTENDED CHOKE TUBES:** Predator, Turkey and wrench.

**FINISH:** Mossy Oak® Overwatch™

**SIGHTS:** Red-bar front sight.

**STOCK:** SteadyGrip™

**SHIM KIT**

**PARACORD SLING**

**OPTIONAL FEATURES**

**BARRELS:** Variety of lengths and finishes.

**STOCKS:** Standard field stock.

**WEAVER SCOPE BASE**

**RECOIL REDUCER**

**MODEL 3500 PREDATOR/TURKEY SPECIAL**

ITEM NUMBER	BARREL LENGTH	STOCK	OVERALL LENGTH	AVERAGE WEIGHT	MSRP
<b>12-GAUGE 2¾" AND 3"</b>					
NEW 36037	24"	Mossy Oak Overwatch	46"	7.5 lbs.	\$979

COMMON SPECIFICATIONS: Magazine Capacity: 4+1 Extended Chokes: MOJO Predator and Turkey Type of Sights: Fiber-optic front bead Length of Pull: 14¾" Drop at Heel: 2½" Drop at Comb: 1½" Minimum recommended load: 3-dram, 1¼ ounce. Receiver drilled and tapped for scope mounting.

SPECIFICATIONS AND PRICES SUBJECT TO CHANGE WITHOUT NOTICE.



Comes with two MOJO specialty chokes and finishes.



A ported barrel mitigates the recoil of heavy, hard-hitting turkey loads and the red fiber-optic front sight is easy to see in low light.



A strong and silent paracord sling is included with the M3500 Predator/Turkey shotgun.



**Model 3000**  
Stoeger's 3" workhorse



**MODEL 3000 – 12-GA, 3"**  
ITEM # 36016 Black synthetic

The Model 3000 comes with a red-bar front sight for quick and easy target acquisition even in low-light conditions.

Stoeger's Model 3000 is a 3-inch-chambered, 12-gauge, Inertia Driven® semi-automatic shotgun that handles loads up to 3-inch magnums without adjustment. For reliability and performance, no other semi-auto in its price range compares to the M3000.



**MODEL 3000 – 12-GA, 3"**  
ITEM # 36006 Mossy Oak® Bottomland™



**MODEL 3000 – 12-GA, 3"**  
ITEM # 36017 Realtree® Max-7™



**NEW** **MODEL 3000 – 12-GA, 3"**  
ITEM # 36039 Black synthetic



**NEW** **MODEL 3000 COMPACT – 12-GA, 3"**  
ITEM # 36036 Black synthetic

Introducing the M3000 Compact—with a shortened stock that offers a 13½" length of pull, Stoeger has created the perfect fitting gun for small-statured hunters and shooters.



**MODEL 3000**

ITEM NUMBER	BARREL LENGTH	STOCK	OVERALL LENGTH	AVERAGE WEIGHT	MSRP
<b>12-GAUGE 2¾" AND 3"</b>					
36016	28"	Black synthetic	49.75"	7.4 lbs.	\$599
36018	26"	Black synthetic	47.75"	7.3 lbs.	\$599
<b>NEW</b> 36063	28"	Black synthetic (Left-Handed)	49.75"	7.4 lbs.	\$599
36006	26"	Mossy Oak® Bottomland™	47.75"	7.3 lbs.	\$649
36023	26"	Realtree® Max-7™	47.75"	7.3 lbs.	\$649
36017	28"	Realtree® Max-7™	49.75"	7.4 lbs.	\$649
36015	28"	Mossy Oak® Bottomland™	49.75"	7.4 lbs.	\$649
<b>NEW</b> 36039	18.5"	Pistol Grip Black synthetic	40.25"	7 lbs.	\$649
<b>NEW</b> 36064	28"	Satin walnut	49.75"	7.4 lbs.	\$799
36020	28"	Satin walnut	49.75"	7.4 lbs.	\$649
36045	28"	Max-7™/Burnt Bronze	49.75"	7.4 lbs.	\$699
36052	28"	Satin walnut/Burnt Bronze	49.75"	7.4 lbs.	\$699

COMMON SPECIFICATIONS: Magazine Capacity: 4+1 Chokes: IC, M, XFT Type of Sights: Red-bar Length of Pull: 14½" Drop at Heel: 2½" Drop at Comb: 1½" Minimum recommended load: 3-dram, 1½ ounce. Receiver drilled and tapped for scope mounting.

**MODEL 3000 SPORTING**

ITEM NUMBER	BARREL LENGTH	STOCK	OVERALL LENGTH	AVERAGE WEIGHT	MSRP
<b>12-GAUGE 2¾" AND 3"</b>					
36034	30"	Black synthetic	51.75"	7.5 lbs.	\$699

COMMON SPECIFICATIONS: Magazine Capacity: 4+1 Choke: SK1, IC, SK2 Type of Sights: Red-bar Length of Pull: 14½" Drop at Heel: 2½" Drop at Comb: 1½" Minimum recommended load: 3-dram, 1½ ounce.

**MODEL 3000 COMPACT**

ITEM NUMBER	BARREL LENGTH	STOCK	OVERALL LENGTH	AVERAGE WEIGHT	MSRP
<b>12-GAUGE 2¾" AND 3"</b>					
<b>NEW</b> 36036	26"	Black synthetic	46.5"	7 lbs.	\$599

COMMON SPECIFICATIONS: Magazine Capacity: 4+1 Chokes: IC, M, XFT Type of Sights: Red-bar Length of Pull: 13½" Drop at Heel: 1¾" Drop at Comb: 1¼" Minimum recommended load: 3-dram, 1½ ounce. Receiver drilled and tapped for scope mounting.

**STANDARD FEATURES**

**CHOKE TUBES:** IC, M, XFT and wrench.  
**FINISHES:** Realtree® Max-7™ Mossy Oak® Bottomland™ Max-7™/Cerakote Burnt Bronze, Black synthetic, Satin walnut or Satin walnut/Cerakote Burnt Bronze.  
**SIGHTS:** Red-bar front sight.  
**SHIM KIT**

**OPTIONAL FEATURES**

**BARRELS:** Variety of lengths and finishes.  
**STOCKS:** SteadyGrip™ and standard field stock.  
**WEAVER SCOPE BASE**  
**RECOIL REDUCER** (Does NOT fit M3000 with wood buttstock)

SPECIFICATIONS AND PRICES SUBJECT TO CHANGE WITHOUT NOTICE.

# Model 3000 Signature Celebrating a Century



**Model 3000 100th Anniversary Signature**  
Classical styling blends with calloused-hand craftsmanship as Stoeger marks 100 years of excellence with the Model 3000 100th Anniversary Signature edition. This stunning semi-auto comes with a 3-inch chamber and boasts Stoeger's Inertia Driven® system. Luxurious satin walnut furniture harkens to Stoeger's rich heritage while the rugged nickel-and-scrollwork receiver and polished-blue 28-inch barrel provide a sleek two-tone accent. Fiber-optic sights ensure fast alignment for all-day upland adventures.



**NEW** MODEL 3000 SIGNATURE – 12-GA, 3"  
ITEM # 36064 Satin walnut, Nickel

- STANDARD FEATURES**  
**CHOKE TUBES:** IC, M, XFT and wrench.  
**FINISHES:** Nickel Receiver, Polished Blue Barrel, Satin walnut  
**SIGHTS:** Fiber Optic  
**SHIM KIT**
- OPTIONAL FEATURES**  
**BARRELS:** Variety of lengths and finishes.  
**STOCKS:** SteadyGrip™ and standard field stock.  
**WEAVER SCOPE BASE**

**MODEL 3000 SIGNATURE**

ITEM NUMBER	BARREL LENGTH	STOCK	OVERALL LENGTH	AVERAGE WEIGHT	MSRP
<b>12-GAUGE 2¾" AND 3"</b>					
NEW 36064	28"	Satin walnut	49.75"	7.4 lbs.	\$799

COMMON SPECIFICATIONS: Magazine Capacity: 4+1 Chokes: IC,M,XFT Type of Sights: Red-bar Length of Pull: 14¾" Drop at Heel: 2½" Drop at Comb: 1½" Minimum recommended load: 3-dram, 1¼ ounce. Receiver drilled and tapped for scope mounting.

SPECIFICATIONS AND PRICES SUBJECT TO CHANGE WITHOUT NOTICE.



**Model 3000 R**  
A slug gun with a twist



**MODEL 3000 R – 12-GA, 3"**  
ITEM # 36031 Black synthetic  
(Burris Droptine scope and rings not included)

The Inertia Driven® M3000 R slug gun has a 24" slug barrel, with a 1:35 rate of twist that makes consistent accuracy the rule, not the exception, even at longer ranges. This gun is practical, reliable and great for hunting in states with shotgun-slug-only regulations.

**STANDARD FEATURES**

**FINISHES:** Black synthetic.  
**CANTILEVERED PICATINNY OPTICS RAIL SHIM KIT**

**OPTIONAL FEATURES**

**BARRELS:** Variety of lengths and finishes.  
**STOCKS:** SteadyGrip™ and standard field stock.  
**RECOIL REDUCER**

The M3000 R comes standard with a cantilevered picatinny rail system to make optics mounting quick and easy. Burris Droptine 2x-7x by 35mm Slug Gun scope and rings not included.



**MODEL 3000 R**

ITEM NUMBER	BARREL LENGTH	STOCK	OVERALL LENGTH	AVERAGE WEIGHT	MSRP
<b>12-GAUGE 2¾" AND 3"</b>					
36031	24"	Black synthetic	45.75"	7.2 lbs.	\$649

COMMON SPECIFICATIONS: Magazine Capacity: 4+1 Cantilever Rifled Barrel: 1:35 twist Length of Pull: 14½" Drop at Heel: 2½" Drop at Comb: 1½" Minimum recommended load: 3-dram, 1½ ounce. Receiver drilled and tapped for scope mounting.

**M3K 3-Gun Model**  
The need for speed



**M3K**

**MODEL 3000 – 12-GA, 3"**  
ITEM # 36038 Black synthetic

The M3K 3-Gun shotgun comes race-ready and gets you up and competing right out of the box. With an oversized bolt release and safety, extended bolt handle, and beveled loading port, the M3K is very reliable and super-fast on the reload. This is a 3-Gun shotgun that can deliver the goods without breaking the bank.

**STANDARD FEATURES**

**EXTENDED CHOKE TUBES:** C, IC, M and wrench.  
**FINISHES:** Black synthetic.  
**SIGHTS:** Red-bar front sight.  
**SHIM KIT**

**OPTIONAL FEATURES**

**BARRELS:** Variety of lengths and finishes.  
**STOCKS:** SteadyGrip™ and standard field stock.  
**WEAVER SCOPE BASE**  
**RECOIL REDUCER**



The M3K comes with oversized, anodized aluminum bolt release, oversized safety, and extended tactical-style anodized aluminum bolt handle. The triad of components makes for quick and easy operation when seconds count.



And for quicker and easier reloading, the M3K features a custom elongated carrier and enlarged, beveled loading port.

**M3K**

ITEM NUMBER	BARREL LENGTH	STOCK	OVERALL LENGTH	AVERAGE WEIGHT	MSRP
<b>12-GAUGE 2¾" AND 3"</b>					
36038	24"	Black synthetic	45.75"	6.9 lbs.	\$699

COMMON SPECIFICATIONS: Magazine Capacity: 4+1 Extended Chokes: C, IC, M Type of Sights: Red-bar Length of Pull: 14½" Drop at Heel: 2½" Drop at Comb: 1½" Minimum recommended load: 3-dram, 1½ ounce. Receiver drilled and tapped for scope mounting.

SPECIFICATIONS AND PRICES SUBJECT TO CHANGE WITHOUT NOTICE.

## Model 3020

Lightweight 20-gauge performance



**MODEL 3020 – 20-GA, 3"**  
ITEM # 36002 Realtree® Max-7™, Cerakote Burnt Bronze



**MODEL 3020 – 20-GA, 3"**  
ITEM # 36004 Mossy Oak® Bottomland™

The M3020 3-inch-chambered, 20-gauge, Inertia Driven® semi-automatic shotgun joins Stoeger's line of high-quality, affordable firearms. Versatility, value and solid reliability make the M3020 ideal for waterfowl, wild turkey or upland game. The M3020 handles a full range of loads, from 2¾-inch up to the potent 3-inch magnum without adjustment. For reliability and performance, no other 20-ga. semi-auto in its price range compares.



**MODEL 3020 – 20-GA, 3"**  
ITEM # 36012 Satin walnut, Cerakote Burnt Bronze



**MODEL 3020 – 20-GA, 3"**  
ITEM # 36030 Mossy Oak® Obsession™



**NEW MODEL 3020 COMPACT – 20-GA, 3"**  
ITEM # 36003 Black synthetic

Stoeger has created an easy-handling, short-stocked, auto-loading 20-gauge that offers a 13½" length of pull. The M3020 compact is great for smaller-framed shooters who prefer the fit and feel of a lightweight, compact shotgun.

### MODEL 3020 COMPACT

ITEM NUMBER	BARREL LENGTH	STOCK	OVERALL LENGTH	AVERAGE WEIGHT	MSRP
<b>20-GAUGE 2¾" AND 3"</b>					
<b>NEW</b> 36003	26"	Black synthetic	46.5"	5.5 lbs.	\$599

**COMMON SPECIFICATIONS:** Magazine Capacity: 4+1 Chokes: IC,M,XFT Type of Sights: Red-bar Length of Pull: 13½" Drop at Heel: 1¾" Drop at Comb: 1¼" Minimum recommended load: ⅞ ounce, 1275 FPS

The Stoeger Model 3020 incorporates a red-bar fiber-optic front sight for quick and easy sighting, even in low-light conditions.



Stoeger's M3020's pistol grip cap displays the distinctive blue Stoeger logo, and the synthetic buttstock includes a shim kit for drop and cast adjustment. The Stoeger M3020 safety is conveniently located on the rear of the trigger guard.

The Model 3020 bolt assembly is an integral part of the Inertia Driven® System. Two key features of the system include an inertia spring and a rotating locking bolt head.



### MODEL 3020

ITEM NUMBER	BARREL LENGTH	STOCK	OVERALL LENGTH	AVERAGE WEIGHT	MSRP
<b>20-GAUGE 2¾" AND 3"</b>					
36007	26"	Black synthetic	47.75"	5.6 lbs.	\$599
36001	28"	Realtree® Max-7™	49.75"	5.7 lbs.	\$649
36004	26"	Mossy Oak® Bottomland™	47.75"	5.6 lbs.	\$649
36010	28"	Black synthetic	49.75"	5.7 lbs.	\$599
36012	28"	Satin walnut/Burnt Bronze	49.75"	5.7 lbs.	\$699
36002	28"	Realtree® Max-7™/Burnt Bronze	49.75"	5.7 lbs.	\$699
36030*	24"	Mossy Oak® Obsession™	45.75"	5.5 lbs.	\$649

**COMMON SPECIFICATIONS:** Magazine Capacity: 4+1 Chokes: IC,M,XFT (36030 XFT Only) Type of Sights: Red-bar (\*Ghost-ring sights on item 36030) Length of Pull: 14½" Drop at Heel: 2" Drop at Comb: 1¼" Minimum recommended load: ⅞ ounce, 1200 FPS

#### STANDARD FEATURES

**CHOKE TUBES:** IC, M, XFT and wrench (36030 XFT Only).  
**FINISHES:** Realtree® Max-7™, Black synthetic, Mossy Oak® Bottomland™, Mossy Oak® Obsession™, Realtree® Max-7™ /Cerakote Burnt Bronze or Satin walnut/Cerakote Burnt Bronze.  
**SIGHTS:** Red-bar front sight (Ghost-ring sights on 36030).  
**SHIM KIT**

#### OPTIONAL FEATURES

**BARRELS:** Variety of lengths and finishes.

**M3020 Upland Special**  
Light, quick and supremely reliable



An anodized silver receiver complements the handsome gloss walnut stock while incorporating the legendary and reliable Inertia Driven System.



**MODEL 3020 UPLAND SPECIAL**  
**20-GA, 3"**  
ITEM # 36011 Gloss walnut,  
Anodized silver, polished blue

On days your upland hunts take you trekking through miles of habitat, you'll be grateful to own such a lightweight shotgun. It's a fast-shooting, easy-swinging, bird-dropping machine that looks as great as it shoots.

**STANDARD FEATURES**

**EXTENDED CHOKE TUBES:** IC, M, F and wrench.  
**FINISHES:** Gloss walnut with anodized silver receiver and polished blue barrel.  
**SIGHTS:** Red-bar front sight.  
**SHIM KIT**

**OPTIONAL FEATURES**

**BARRELS:** Variety of lengths and finishes.

**M3020 UPLAND SPECIAL**

ITEM NUMBER	BARREL LENGTH	STOCK	OVERALL LENGTH	AVERAGE WEIGHT	MSRP
<b>20-GAUGE 2 3/4" AND 3"</b>					
36011	26"	Gloss walnut	47.75"	5.6 lbs.	\$699

COMMON SPECIFICATIONS: Magazine Capacity: 4+1 Extended Chokes: IC, M, F  
Type of Sights: Red-bar Length of Pull: 14 1/4" Drop at Heel: 2" Drop at Comb: 1 1/4"  
Minimum recommended load: 7/8 ounce, 1200 FPS.

SPECIFICATIONS AND PRICES SUBJECT TO CHANGE WITHOUT NOTICE.



The M3020 Upland Special incorporates a red-bar fiber-optic front sight for quick and easy sighting, even in low-light conditions.

# P3500 Pump

Magnum performance at a friendly price



**P3500 – 12-GA, 3½"**  
ITEM # 36059 Realtree® Max-7™



**P3500 – 12-GA, 3½"**  
ITEM # 31880 Black synthetic



A chrome-lined, ventilated rib barrel with a red-bar front sight and a screw-in modified choke comes standard on the P3500.

The rotating bolt head ensures a positive steel-to-steel lockup that provides the Stoeger pump with strength and reliability.



The P3500 and its stablemate the P3000, is packed full of features such as a chrome-lined barrel, dual-action bars and a rotating bolt head, to name a few, and is chambered to deftly handle up to 3½" magnum loads. Its ergonomic styling with sleek, thin forend profile makes for a pleasingly smooth swing and instinctive pointing. The rock-solid P3500 pump gun also comes in at a price that will make even the most budget-conscious hunter smile.

### P3500 PUMP SHOTGUN

ITEM NUMBER	BARREL LENGTH	STOCK	OVERALL LENGTH	AVERAGE WEIGHT	MSRP
<b>12-GAUGE 2¾", 3" AND 3½"</b>					
31880	28"	Black synthetic	50"	7.1 lbs.	\$399
31881	26"	Black synthetic	48"	7.0 lbs.	\$399
36059	28"	Realtree® Max-7™	50"	7.1 lbs.	\$449
36058	26"	Realtree® Max-7™	48"	7.0 lbs.	\$449

COMMON SPECIFICATIONS: Magazine Capacity: 4+1 Chokes: M Type of Sights: Red-bar front sight Length of Pull: 14½" Drop at Heel: 2½" Drop at Comb: 1½"

### STANDARD FEATURES

**CHOKE TUBES:** M and wrench.  
**FINISHES:** Realtree® Max-7™, Black synthetic.  
**SIGHTS:** Red-bar front sight.

The Stoeger P3500 is fitted with a checkered, synthetic stock that has an integrated swivel stud for easy sling attachment, and a recoil-absorbing, rubber buttpad. An inset Stoeger logo grip cap is under the pistol grip.



A precision-machined, anodized aluminum receiver and an easily accessible cross-bolt safety speak to the practical, well-designed, quality craftsmanship found in the P3500.

The dual action bars of the P3500 provide smooth, solid, reliable operation of the pump-action. The twin parallel steel bars evenly distribute the force used to manipulate the manual action, preventing twisting and binding from occurring during ejection of a discharged shotshell and the loading of a new round into the chamber.



## P3000 Pump

Durable dependability that doesn't break the bank



**P3000 – 12-GA, 3"**  
ITEM # 31861 Black synthetic

Stoeger's P3000 sets the standard for dependability at a wallet-friendly price. This no-nonsense shotgun from Stoeger will reliably handle any 12-gauge load from 2¾" field rounds to 3" magnums.

The Stoeger P3000 features a chrome-lined, ventilated-rib barrel with a red-bar front sight and a screw-in modified choke.



The Stoeger P3000 pump-action shotgun sports a precision-machined, anodized aluminum receiver and an easily accessible cross-bolt safety found at the rear of the trigger guard.



**P3000 – 12-GA, 3"**  
ITEM # 36056 Realtree® Max-7™



The checkered, black synthetic stock of the P3000 includes an integrated swivel stud for quick and easy sling attachment, and a rubber buttpad for recoil absorption. The pistol grip is inset with a Stoeger logo cap.



**P3000 – 12-GA, 3"**  
ITEM # 31921 Satin walnut

### STANDARD FEATURES

**CHOKE TUBES:** M and wrench.  
**FINISHES:** Realtree® Max-7™, Black synthetic, or Satin walnut.  
**SIGHTS:** Red-bar front sight.

### P3000 PUMP SHOTGUN

ITEM NUMBER	BARREL LENGTH	STOCK	OVERALL LENGTH	AVERAGE WEIGHT	MSRP
<b>P3000 12-GAUGE 2¾", AND 3"</b>					
31856	28"	Black synthetic	49.5"	6.9 lbs.	\$329
31861	26"	Black synthetic	47.5"	6.8 lbs.	\$329
36056	28"	Realtree® Max-7™	49.5"	6.9 lbs.	\$399
36057	26"	Realtree® Max-7™	47.5"	6.8 lbs.	\$399
31921	28"	Satin walnut	49.5"	6.9 lbs.	\$399

COMMON SPECIFICATIONS: Magazine Capacity: 5+1 Chokes: M Type of Sights: Red-bar front sight Length of Pull: 14½" Drop at Heel: 2½" Drop at Comb: 1½"

One of the many winning features of the P3000 is its barrel extension. By reaching well into the receiver, this portion of the barrel saves wear and adds longevity to the action. Also, it makes cycling smoother and helps eject shells more reliably.



# STR Series Handguns

## Unfailing Performance When it Matters Most

The new STR handguns enter 2024 with some exciting model editions such as the first ever STR chambered in .45 ACP and a new Combat X that is designed to exceed the rigors of international military specifications. In addition, we've added some amazing new colors in our mid-sized models that are available in a wide array of configurations.

(see below for new colors)



**NEW**

**STR-9 - 9MM**  
ITEM # 317A25 - Tungston Cerakote,  
Meprolight Hyperbright Sights



**NEW**

**STR-9 - 9MM**  
ITEM # 317A20 - OD Green Cerakote



**NEW**

**STR-9 - 9MM**  
ITEM # 317A22 - FDE Cerakote



**NEW**

**STR-9 - 9MM**  
ITEM # 317A27 - FDE Distressed Cerakote

**NEW**  
For 2024



**NEW** STR-9 - COMBAT X  
ITEM # 31776 Black synthetic, nitride-hardened matte black



**NEW** STR-9 - 9MM  
ITEM # 317A20 OD Green Cerakote



**NEW** STR-45 - 45 ACP  
ITEM # 31799 Black synthetic, nitride-hardened matte black



**NEW** STR-9 - 9MM  
ITEM # 317A27 FDE Distressed Cerakote



**NEW** STR-9 - 9MM  
ITEM # 317A22 FDE Cerakote



**NEW** STR-9 - 9MM  
ITEM # 317A25 Tungston Cerakote, Meprolight Hyperbright Sights

**STANDARD FEATURES**  
**ACTION:** Striker-fired.  
**TRIGGER SAFETY**  
**SIGHTS:** Quick read three-dot sight.  
**CABLE LOCK:** Included with every pistol for safe storage.  
**BACKSTRAPS (M, L)**

**STR-45 PISTOL**

ITEM NUMBER	CALIBER	FINISH	WEIGHT UNLOADED	MAG CAPACITY	MSRP
<b>STR-45, 2 MAGAZINES, 2 BACKSTRAPS (M, L), TRITIUM NIGHT SIGHTS, OPTIC READY</b>					
<b>NEW</b> 31799	45 ACP	Black synthetic, Nitride slide	27 oz.	10+1	\$529
<b>NEW</b> 31798	45 ACP	Black synthetic, Nitride slide	27 oz.	13+1	\$529
<b>STR-45, 2 MAGAZINES, 2 BACKSTRAPS (M, L)</b>					
<b>NEW</b> 31797	45 ACP	Black synthetic, Nitride slide	27 oz.	10+1	\$449
<b>NEW</b> 31796	45 ACP	Black synthetic, Nitride slide	27 oz.	13+1	\$449

COMMON SPECIFICATIONS: **Action:** Striker-fired **Sights:** Quick read three-dot sight  
**Overall Length:** 7.95" **Barrel Length:** 5.18"

**Performance...with an Attitude**

To satisfy contemporary tastes in defensive handgun color schemes, Stoeger introduces a new line of standard-size STR-9 pistols in several popular subdued hues. Each pistol stands out on the range, but they also distinguish themselves for quick identification when needed. Color-coordinating frame and Cerakote slide combinations include OD Green, FDE, and Distressed FDE. Also new is the Tungsten Cerakote model featuring Meprolight Hyperbright day/night sights.

**STR-9 PISTOL**

ITEM NUMBER	CALIBER	FINISH	WEIGHT UNLOADED	MAG CAPACITY	MSRP
<b>STR-9, 2 MAGAZINES, 3 BACKSTRAP (S,M,L)</b>					
<b>NEW</b> 317A27	9mm	FDE Distressed, FDE Distressed	26.4 oz.	10+1	\$499
<b>NEW</b> 317A25	9mm	Meprolight, Tungsten slide	26.4 oz.	10+1	\$549
<b>NEW</b> 317A24	9mm	Meprolight, Tungsten slide	26.4 oz.	15+1	\$549
<b>NEW</b> 317A26	9mm	FDE Distressed, FDE Distressed	26.4 oz.	15+1	\$499
<b>STR-9, 2 MAGAZINES, 3 BACKSTRAPS (S,M,L)</b>					
<b>NEW</b> 317A22	9mm	FDE, FDE slide	26.4 oz.	15+1	\$549
<b>NEW</b> 317A20	9mm	OD Green, OD Green	26.4 oz.	15+1	\$549
<b>NEW</b> 317A21	9mm	OD Green, OD Green	26.4 oz.	10+1	\$549
<b>STR-9 COMBAT X, 3 MAGAZINES, OPTIC READY, FO SIGHTS</b>					
<b>NEW</b> 31776	9mm	Black synthetic, Nitride slide	28 oz.	10+1	\$599
<b>NEW</b> 31775	9mm	Black synthetic, Nitride slide	28 oz.	17+1	\$599

COMMON SPECIFICATIONS: **Action:** Striker-fired **Sights:** Quick read three-dot sight (Items 317A22, 317A20, 317A21 tritium night sights) **Overall Length:** 7.44" **Barrel Length:** 4.17"

**Next Level Defense**

With the resurging demand for defensive pistols, Stoeger introduces the all-new STR-9 Combat X and the STR-45. Both polymer-frame, striker-fired handguns are built around Stoeger's rugged and reliable platforms to provide enhanced control and accuracy. The STR-45 is the first Stoeger, full-sized handgun chambered in the hard-hitting .45 ACP cartridge, with a straight front strap and interchangeable backstraps for a custom fit. The STR-45 comes in 13+1 or 10+1 round capacity with either quick-read 3-dot sights or with tritium night sights and an optic-ready slide cut. The STR-9 Combat-X is designed to meet the needs of defense professionals with its standard fiber-optic sights, optic-ready slide configuration, enlarged mag well, and ambidextrous slide release. Further, this 9mm is validated for 10,000 rounds of continuous fire without failure.

## STR Micro Compact

Discreet carry



When discreet carry is a must, look no further than the STR Micro Compact. You get the same rugged reliability and features found in full-size STR models in a pistol that's easier to conceal. The trigger is outstanding, and there are multiple sight options to choose from. An 10-and 13-rd. magazine are included (10-rd. mags for states with a limit).

### STANDARD FEATURES

**ACTION:** Striker-fired.

**TRIGGER SAFETY**

**MAGAZINE:**

Flush: 11-round

Pinky: 11-round

Extended: 13-round

31766: 1 flush, 1 extended

31768: 1 flush, 1 extended

31770: 1 flush, 1 extended, 1 pinky

31771: 1 flush, 1 extended, 1 pinky

**CABLE LOCK:** Included with every pistol for safe storage.



**STR-9MC - 9MM**  
ITEM # 31766 Black synthetic, nitride-hardened matte black



Comes with flush and extended pinky magazines.

STR-9MC MICRO COMPACT PISTOL					
ITEM NUMBER	CALIBER	FINISH	WEIGHT UNLOADED	MAG CAPACITY	MSRP
<b>STR-9MC, 2 MAGAZINES, LOW PROFILE ADJUSTABLE SIGHTS</b>					
31766	9mm	Black synthetic, Nitride slide	18.5 oz.	13+1	\$399
31768	9mm	Black synthetic, Nitride slide	18.5 oz.	10+1	\$399
<b>STR-9MC, 3 MAGAZINES, TRITIUM NIGHT SIGHTS, OPTIC READY</b>					
31770	9mm	Black synthetic, Nitride slide	18.5 oz.	13+1	\$479
31771	9mm	Black synthetic, Nitride slide	18.5 oz.	10+1	\$479

COMMON SPECIFICATIONS: **Action:** Striker-fired **Sights:** Low-profile adjustable (31770, 31771 adjustable night sights) **Overall Length:** 6.1" **Barrel Length:** 3.29"

## STR Sub-Compact

Your new EDC pistol has arrived



Dependable performance in a smaller size Stoeger developed this sub-compact version of the STR with concealed carry in mind. It has all the power, reliability, performance and safety features that are standard in STR line, and delivers them in a more compact version that is optimized for every-day carry.

### STANDARD FEATURES

**ACTION:** Striker-fired.

**TRIGGER SAFETY**

**SIGHTS:** Quick read three-dot sight

**CABLE LOCK:** Included with every pistol for safe storage.



Overall length of the STR Sub-Compact is 6.54" compared to 7.44" for the standard STR's.

**STR-9SC SUB-COMPACT - 9MM**  
ITEM # 31750 Black synthetic, nitride-hardened matte black



All STR Sub-Compact models come with a three-dot sight system that has snag-resistant edges for smooth draws and holstering. All can also be ordered with optional tritium night sights (as shown at left).

### STR-9SC SUB-COMPACT PISTOL

ITEM NUMBER	CALIBER	FINISH	WEIGHT UNLOADED	MAG CAPACITY	MSRP
<b>STR-9SC, 1 MAGAZINE, 1 BACKSTRAP (M)</b>					
31750	9mm	Black synthetic, Nitride slide	22.4 oz.	10+1	\$329
<b>STR-9SC, 2 MAGAZINES, 3 BACKSTRAPS (S,M,L), OPTIC READY</b>					
31792	9mm	Black synthetic, Nitride slide	22.4 oz.	10+1	\$399

COMMON SPECIFICATIONS: **Action:** Striker-fired **Sights:** Quick read three-dot sight **Overall Length:** 6.54" **Barrel Length:** 3.54"



## STR Compact

Optimized for concealed carry



### Every day tough meets every day carry

Stoeger's STR Compact semi-automatic pistol sets the personal defense pistol bar high with features such as an integrated rail, internal safety, reversible magazine release, optimized slide serrations, three-dot sight system and enhanced ergonomics. The STR Compact carries on the legacy by offering all the full-size features, power and reliable performance in a more compact version optimized for concealed carry.

### STANDARD FEATURES

**ACTION:** Striker-fired.

**TRIGGER SAFETY**

**SIGHTS:** Quick read three-dot sight (tritium night sights on items 31790 and 31791).

**CABLE LOCK:** Included with every pistol for safe storage.



Overall length of the STR-9C is 6.9" compared to 7.44" for the standard STR's.

**STR-9C COMPACT – 9MM**  
ITEM # 31730 Black synthetic, nitride-hardened matte black

### STR COMPACT PISTOL

ITEM NUMBER	CALIBER	FINISH	WEIGHT UNLOADED	MAG CAPACITY	MSRP
<b>STR-9C, 1 MAGAZINE, 1 BACKSTRAP (M)</b>					
31730	9mm	Black synthetic, Nitride slide	24 oz.	13+1	\$329
31733	9mm	Black synthetic, Nitride slide	24 oz.	10+1	\$329
<b>STR-9C, 1 PINKY &amp; 1 FLUSH MAGAZINE, 3 BACKSTRAPS (S,M,L), OPTIC READY</b>					
31788	9mm	Black synthetic, Nitride slide	24 oz.	13+1	\$399
31789	9mm	Black synthetic, Nitride slide	24 oz.	10+1	\$399

COMMON SPECIFICATIONS: **Action:** Striker-fired **Sights:** Quick read three-dot sight  
Overall Length: 6.9" Barrel Length: 3.8"

The STR Compact three-dot sight system has snag-resistant edges to ensure smooth draws and holstering. Models with tritium night sights are available (as shown).



## STR Mid-Size

Carry tough



**NEW** **STR-9 – 9MM**  
ITEM # 317A24 Tungsten Cerakote, Meprolight Hyperbright Sights

### Dependable EDC With Practical Style

Delivering the reliability and accuracy expected in a full-size pistol with the handling and carry attributes of smaller handgun, the STR Mid-Size hits the perfect note. With up to 15+1 cartridge capacity and interchangeable backstraps for a custom fit, the mid-sized handgun allows for exceptional ergonomics to match a broad range of shooter sizes. The STR Mid-Size is offered in seven new models for 2024: OD Green, FDE Distressed, and Tungsten Cerakote featuring Meprolight's Hyperbright sight system.

### STANDARD FEATURES

**ACTION:** Striker-fired.

**TRIGGER SAFETY**

**MAGAZINE:** One 10- or 15-round magazine.

**SIGHTS:** Quick read three-dot sight

**CABLE LOCK:** Included with every pistol for safe storage.



STR models (except optic ready) have a feature that lets you check by touch if a round is chambered. A small indicator atop the receiver raises to confirm the presence of a chambered round. It stays flat when the chamber is empty.



**NEW** **STR-9 – 9MM**  
ITEM # 317A27 FDE Distressed Cerakote



**STR-9 – 9MM**  
ITEM # 31782 Black synthetic, nitride-hardened matte black

### STR-9 PISTOL

ITEM NUMBER	CALIBER	FINISH	WEIGHT UNLOADED	MAG CAPACITY	MSRP
<b>STR-9, 1 MAGAZINE, 1 BACKSTRAP (M)</b>					
31720	9mm	Black synthetic, Nitride slide	26.4 oz.	15+1	\$329
31724	9mm	Black synthetic, Nitride slide	26.4 oz.	10+1	\$329
<b>STR-9, 2 MAGAZINES, 3 BACKSTRAP (S,M,L)</b>					
<b>NEW</b> 317A27	9mm	FDE Distressed, FDE Distressed	26.4 oz.	10+1	\$499
<b>NEW</b> 317A25	9mm	Meprolight, Tungsten slide	26.4 oz.	10+1	\$549
<b>NEW</b> 317A24	9mm	Meprolight, Tungsten slide	26.4 oz.	15+1	\$549
<b>NEW</b> 317A26	9mm	FDE Distressed, FDE Distressed	26.4 oz.	15+1	\$499
31782	9mm	Black synthetic, Nitride slide	26.4 oz.	15+1	\$429
31783	9mm	Black synthetic, Nitride slide	26.4 oz.	10+1	\$399
<b>STR-9, 2 MAGAZINES, 3 BACKSTRAPS (S,M,L), TRITIUM NIGHT SIGHTS, OPTIC READY</b>					
<b>NEW</b> 317A22	9mm	FDE, FDE slide	26.4 oz.	15+1	\$549
<b>NEW</b> 317A20	9mm	OD Green, OD Green	26.4 oz.	15+1	\$549
<b>NEW</b> 317A21	9mm	OD Green, OD Green	26.4 oz.	10+1	\$549

COMMON SPECIFICATIONS: **Action:** Striker-fired **Sights:** Quick read three-dot sight (Items 317A22, 317A20, 317A21 tritium night sights) **Overall Length:** 7.44" **Barrel Length:** 4.17"

### STR-40 PISTOL

ITEM NUMBER	CALIBER	FINISH	WEIGHT UNLOADED	MAG CAPACITY	MSRP
<b>STR-40, 1 MAGAZINE, 1 BACKSTRAP (M)</b>					
31767	.40 S&W	Black synthetic, Nitride slide	28 oz.	11+1	\$329

COMMON SPECIFICATIONS: **Action:** Striker-fired **Sights:** Quick read three-dot sight  
Overall Length: 7.44" Barrel Length: 4.17"

## STR Full-Size

Bigger and badder



**STR-9F – COMBAT 9MM**  
ITEM # 31794 Black synthetic,  
nitride-hardened matte black



**NEW STR-45 – 45 ACP**  
ITEM # 31799 Black synthetic,  
nitride-hardened matte black

### Meet the Stoeger Power Team

Designed for hard use and built to satisfy the highest expectations, Stoeger's STR Full-Size handguns are the optimal choice for medium-to large-hand shooters looking for maximum dependability and ample on-board round count. Featuring a nitride-hardened slide, a high-retention/customizable grip and a light/laser rail, the STR Full-Size is an ideal choice for defensive work or competition. With several model configurations available, including the all-new STR-45 in .45 ACP and the new Combat X developed to exceed international military specifications, the STR Full-Size series has a model for every mission at a price well below its performance capabilities.

### STANDARD FEATURES

- ACTION:** Striker-fired.
- TRIGGER SAFETY**
- SIGHTS:** Quick read three-dot sight.
- CABLE LOCK:** Included with every pistol for safe storage.
- BACKSTRAPS (M, L)**

**STR-9F – 9MM**  
ITEM # 31752 Black synthetic,  
nitride-hardened matte black



The STR Full-Size (except optic ready) has a feature that lets you check by touch if a round is chambered. A small indicator atop the receiver raises to confirm the presence of a chambered round. It stays flat when the chamber is empty.

### STR FULL-SIZE PISTOL

ITEM NUMBER	CALIBER	FINISH	WEIGHT UNLOADED	MAG CAPACITY	MSRP
<b>STR-45, 2 MAGAZINES, 2 BACKSTRAPS (M, L), TRITIUM NIGHT SIGHTS, OPTIC READY</b>					
NEW 31799	45 ACP	Black synthetic, Nitride slide	27 oz.	10+1	\$529
NEW 31798	45 ACP	Black synthetic, Nitride slide	27 oz.	13+1	\$529
<b>STR-45, 2 MAGAZINES, 2 BACKSTRAPS (M, L), OPTIC READY</b>					
NEW 31797	45 ACP	Black synthetic, Nitride slide	27 oz.	10+1	\$449
NEW 31796	45 ACP	Black synthetic, Nitride slide	27 oz.	13+1	\$449
<b>STR-9, 1 MAGAZINE, 1 BACKSTRAP (M)</b>					
31752	9mm	Black synthetic, Nitride slide	27 oz.	17+1	\$329
31762	9mm	Black synthetic, Nitride slide	27 oz.	10+1	\$329
<b>STR-9 COMBAT, 3 MAGAZINES, THREADED BARREL, OPTIC READY, 3 BACKSTRAPS (S,M,L), EXTENDED MAGWELL</b>					
31794	9mm	Black synthetic, Nitride slide	26.4 oz.	20+1	\$629

COMMON SPECIFICATIONS: **Action:** Striker-fired **Sights:** Quick read three-dot sight  
Overall Length: 7.95" Barrel Length: 5.18"

## NEW STR-9 Combat X

Everything you need, military tough



**NEW STR-9 – COMBAT X**  
ITEM # 31776 Black synthetic,  
nitride-hardened matte black



### Reliable performance for professional missions

Developed to meet and exceed international military specifications, the all-new STR-9 Combat X is validated for 10K rounds of continuous fire without failure. Fiber-optic sights, optic-ready slide, and enlarged mag well, combined with an ambidextrous slide release and straight grip front strap for a do-it-all mid-size 9mm that is ready for the hard work.



STR Combat's grip is textured for a sure hold in any weather. The enhanced magazine well is beveled to speed up reloading.



Each STR Combat comes with an adjustable fiber-optic sight system.



**STR-9 COMBAT – 9MM**  
ITEM # 31736 Black synthetic,  
nitride-hardened matte black  
(optic not included)

### STANDARD FEATURES

- ACTION:** Striker-fired.
- THREADED BARREL:** Ready to accept a suppressor.
- TRIGGER SAFETY**
- MAGAZINE:** Three 20-round magazines with item 31736 and 31786, 10-round magazine with item 31176, 17-round magazine with item 31775, and three 20-round magazines with item 31786.
- SIGHTS:** Adjustable, fiber-optic sights.
- OPTICS MOUNTING:** Four mounting plates and cover.
- BACKSTRAPS:** Three interchangeable backstraps offer custom fit.
- CABLE LOCK:** Included with every pistol for safe storage.
- ENHANCED MAGWELL**

### STR COMBAT PISTOL

ITEM NUMBER	CALIBER	FINISH	WEIGHT UNLOADED	MAG CAPACITY	MSRP
<b>STR-9 COMBAT, 3 MAGAZINES, 3 BACKSTRAPS (S,M,L)</b>					
31736	9mm	Black synthetic, Nitride slide	28 oz.	20+1	\$629
<b>STR-9 COMBAT X, 3 MAGAZINES</b>					
NEW 31776	9mm	Black synthetic, Nitride slide	28 oz.	10+1	\$599
NEW 31775	9mm	Black synthetic, Nitride slide	28 oz.	17+1	\$599
<b>STR-9 COMBAT+, 3 MAGAZINES, TUNGSTEN CERAKOTE, HOLSTER, 3 BACKSTRAPS (S,M,L), HARD CASE</b>					
31786	9mm	Black synthetic, Tungsten Cerakote slide	28 oz.	20+1	\$679

COMMON SPECIFICATIONS: **Action:** Striker-fired **Sights:** Fiber Optic sights  
Overall Length: 7.94" Barrel Length: 4.67"



# Freedom SERIES

## P3000 Freedom Series Supreme

Protect what's important with Freedom Series Supreme

The shotgun is widely recognized as a superior choice for defending home and property. Our Freedom Series Supreme is packed with features that ensure outstanding performance and reliability in such applications. Ghost-ring sights promote fast target acquisition. A six-position rear stock with an adjustable cheek rest delivers a custom fit, and it folds forward for compact storage and transport. The extended magazine tube holds seven shells. A rubberized pistol grip promotes solid grasp in any weather and helps mitigate hand shock when shooting heavy loads. Don't trust your security and protection to anything less than a Stoeger's Freedom Series Supreme Shotgun.

For this Freedom Series Supreme shotgun Stoeger took the solid operating system of the P3000 and paired it with select U.S. manufactured components. This allowed us to create an extended-capacity P3000 shotgun for our customers which is 922R compliant.



**P3000 DEFENSE, EXTENDED CAPACITY – 12-GA, 3"**  
ITEM # 31894FS Black synthetic

### P3000 FREEDOM SERIES SUPREME PUMP SHOTGUN

ITEM NUMBER	BARREL LENGTH	STOCK	OVERALL LENGTH	AVERAGE WEIGHT	MSRP
<b>12-GAUGE 2¾" AND 3"</b>					
31894FS	18.5"	Black synthetic	40.5"	7.3 lbs.	\$529

COMMON SPECIFICATIONS: Magazine Capacity: 7+1 Choke: Cylinder fixed Type of Sights: Ghost-ring sights Length of Pull: 14½" Drop at Heel: 2½" Drop at Comb: 1½"

#### STANDARD FEATURES

- CHOKE TUBES:** Fixed cylinder.
- FINISH:** Black synthetic.
- SIGHTS:** Ghost-ring sight.
- STOCK:** Side-folding, collapsible, pistol grip.



Freedom Series Supreme shotguns are equipped with telescoping, six-position rear stocks that offer 3.75 inches of length adjustment for optimal fit.



A ghost-ring sight promotes fast target acquisition and the extended magazine holds seven shells. An integrated sling attachment point is located under the magazine tube.



Folding stocks allow for compact storage and transport. The stock also features an adjustable cheek rest and a soft recoil pad for shooting comfort.



**M3K**



## Stoeger Freedom Series Shotguns

Extended magazine 12-gauge powerhouses

Freedom: the power to make choices as you see fit without restraint. So why restrain the capacity of your 12-gauge magazine if you don't have to? Go all the way with the Stoeger Freedom Series, a line of 12-gauge semi-autos and pumps with extended magazine tubes. With out-of-the-box capacity of 7+1 (M3000 Freedom and P3000 Freedom) and 10+1 (M3K), the only thing small on these bad boys is the price tag.

**M3K 3-GUN, EXTENDED CAPACITY – 12-GA, 3"**  
ITEM # 36038FS Black synthetic

Want a real for the buck? The M3K 3-gun shotgun now comes right out of the box with a 10+1-capacity magazine, making it a fantastic choice for the ambitious (yet price conscious) competitor. With its oversized bolt release and safety, extended bolt handle, beveled loading port and extended choke tubes the answer to the question "Are you ready?" is a resounding "Yes!"

For the Freedom Series shotguns Stoeger took the solid operating systems of the M3000 & P3000 and paired them with select U.S.-manufactured components. This allowed us to create extended capacity M3000 & P3000 shotguns for our customers which are 922R compliant.



The M3K comes with an oversized, anodized aluminum bolt release and extended tactical-style anodized aluminum bolt handle. Reloading is made quicker and easier with the custom/elongated carrier and enlarged, beveled loading port.

### M3K FREEDOM SERIES 3-GUN SHOTGUN

ITEM NUMBER	BARREL LENGTH	STOCK	OVERALL LENGTH	AVERAGE WEIGHT	MSRP
<b>12-GAUGE 2¾" AND 3"</b>					
36038FS	24"	Black synthetic	48"	7.3 lbs.	\$749

COMMON SPECIFICATIONS: Magazine Capacity: 10+1 Extended Chokes: C, IC, M Type of Sights: Red-bar Length of Pull: 14¾" Drop at Heel: 2½" Drop at Comb: 1½" Minimum recommended load: 3-dram, 1½ ounce. Receiver drilled and tapped for scope mounting.

### STANDARD FEATURES

**EXTENDED CHOKE TUBES:** C, IC, M and wrench.  
**FINISHES:** Black synthetic.  
**SIGHTS:** Red-bar front sight.  
**SHIM KIT**  
**FULL LENGTH MAGAZINE TUBE**

### OPTIONAL FEATURES

**BARRELS:** Variety of lengths and finishes.  
**STOCKS:** SteadyGrip™ and standard field stock.  
**WEAVER SCOPE BASE**  
**RECOIL REDUCER**



**M3000 DEFENSE, EXTENDED CAPACITY – 12-GA, 3"**  
ITEM # 36033FS Black synthetic



**M3000 DEFENSE, PISTOL GRIP, EXTENDED CAPACITY – 12-GA, 3"**  
ITEM # 31891FS Black synthetic

### STANDARD FEATURES

**CHOKE:** Fixed cylinder.  
**FINISHES:** Black synthetic.  
**SIGHTS:** Ghost-ring sights.  
**WEAVER SCOPE BASE**  
**SHIM KIT**

### OPTIONAL FEATURES

**BARRELS:** Variety of lengths & finishes.  
**STOCKS:** SteadyGrip™ & standard field stock.  
**RECOIL REDUCER**

### MODEL 3000 FREEDOM SERIES DEFENSE SHOTGUN

ITEM NUMBER	BARREL LENGTH	STOCK	OVERALL LENGTH	AVERAGE WEIGHT	MSRP
<b>12-GAUGE 2¾" AND 3"</b>					
36033FS	18.5"	Black synthetic	40.75"	6.6 lbs.	\$649
31891FS	18.5"	Black synthetic Pistol Grip	40.75"	7.0 lbs.	\$699

COMMON SPECIFICATIONS: Magazine Capacity: 7+1 Choke: Cylinder fixed Type of Sights: Ghost-ring sights Length of Pull: 14¾" Drop at Heel: 2½" Drop at Comb: 1½" Minimum recommended load: 3-dram, 1½ ounce. Receiver drilled and tapped for scope mounting.



**P3000 DEFENSE, EXTENDED CAPACITY – 12-GA, 3"**  
ITEM # 31892FS Black synthetic

### P3000 FREEDOM SERIES DEFENSE PUMP SHOTGUN

ITEM NUMBER	BARREL LENGTH	STOCK	OVERALL LENGTH	AVERAGE WEIGHT	MSRP
<b>12-GAUGE 2¾" AND 3"</b>					
31892FS	18.5"	Black synthetic	40.5"	6.3 lbs.	\$399

COMMON SPECIFICATIONS: Magazine Capacity: 7+1 Choke: Cylinder fixed Type of Sights: Blade front sight Length of Pull: 14¾" Drop at Heel: 2½" Drop at Comb: 1½"

SPECIFICATIONS AND PRICES SUBJECT TO CHANGE WITHOUT NOTICE.

The only thing cooler than the sound of a pump-action being cycled is knowing that you have enough firepower on tap to outlast most shotguns on the planet. The P3000 Freedom Series has all the features of its standard-capacity cousin, plus an extra 3 shots (7+1 capacity).

### P3000 DEFENSE STANDARD FEATURES

**CHOKE TUBES:** Fixed cylinder.  
**FINISH:** Black synthetic.  
**SIGHTS:** Blade sight.

## Stoeger Defense Line

Reliable. Durable. Affordable.



**P3000 DEFENSE – 12-GA, 3"**  
ITEM # 31892 Black synthetic

**P3000 DEFENSE, PISTOL GRIP – 12-GA, 3"**  
ITEM # 31893 Black synthetic

Our expanding lineup of defense shotguns has set new industry benchmarks for reliability and affordability. You can choose between pump-action, side-by-side, over/under and semi-automatic, between 12- and 20-gauge, and between standard or pistol-grip configurations. *(double-barrel defense shotguns on page 42)*

### P3000 DEFENSE STANDARD FEATURES

**CHOKE TUBES:** Fixed cylinder.  
**FINISH:** Black synthetic.  
**SIGHTS:** Blade sight.

The Stoeger P3000 Defense comes with a standard stock or with a pistol-grip stock which allows for optimal control.

### P3000 DEFENSE PUMP SHOTGUN

ITEM NUMBER	BARREL LENGTH	STOCK	OVERALL LENGTH	AVERAGE WEIGHT	MSRP
<b>12-GAUGE 2¾" AND 3"</b>					
31892	18.5"	Black synthetic	40"	6.4 lbs.	\$329
31893	18.5"	Black synthetic Pistol Grip	40"	6.4 lbs.	\$399

COMMON SPECIFICATIONS: **Magazine Capacity:** 5+1 **Choke:** Cylinder fixed **Type of Sights:** Blade front sight **Length of Pull:** 14½" **Drop at Heel:** 2½" **Drop at Comb:** 1½"

## Double Defense

On the front line of defense



**DOUBLE DEFENSE SIDE-BY-SIDE — 20-GA, 3"**  
ITEM # 31447 Matte black-finished walnut  
(Burris® sight and flashlight not included)



**DOUBLE DEFENSE SIDE-BY-SIDE — 12-GA, 3"**  
ITEM # 31446 Black synthetic



**DOUBLE DEFENSE OVER/UNDER — 12-GA, 3"**  
ITEM # 31089 Black synthetic  
(Burris® sight and flashlight not included)  
Also available in 20-gauge.



The Double Defense Side-by-Side's 20-inch barrels are ported to keep muzzle climb down and fitted with a green, fiber-optic front sight for fast, sure target acquisition in low-light conditions. (light not included)



The Double Defense's single-trigger design and tang-mounted automatic safety makes it a fast and reliable firearm that's ideal for home security use.



The Double Defense comes standard with two Picatinny rails for sighting aids and optics; the bottom Picatinny rail is factory-installed and will also accommodate accessories. (optic not included)

### DOUBLE DEFENSE

ITEM NUMBER	BARREL LENGTH	STOCK	OVERALL LENGTH	AVERAGE WEIGHT	MSRP
<b>DOUBLE DEFENSE SIDE-BY-SIDE 12-GAUGE 2¾" AND 3"</b>					
31446	20" Ported	Black synthetic	36.5"	7.0 lbs.	\$529
<b>DOUBLE DEFENSE SIDE-BY-SIDE 20-GAUGE 2¾" AND 3"</b>					
31447	20" Ported	Black-finished walnut	36.5"	6.4 lbs.	\$529
<b>DOUBLE DEFENSE OVER/UNDER 12-GAUGE 2¾" AND 3"</b>					
31089	20"	Black synthetic	36.5"	7.1 lbs.	\$499
<b>DOUBLE DEFENSE OVER/UNDER 20-GAUGE 2¾" AND 3"</b>					
31088	20"	Black-finished walnut	36.5"	6.6 lbs.	\$499

COMMON SPECIFICATIONS: Chokes: IC/IC fixed Type of Sights: Fiber-optic front sight Length of Pull: 14½" Drop at Heel: 2½" Drop at Comb: 1½" Shell Extractor

Available in 12- and 20-gauge models, the Stoeger Double Defense is ideal for use in tight quarters and tense situations. The traditional break-action and short, efficient design is easy to load and quick to deploy in an emergency.

#### STANDARD FEATURES

- CHOKES:** Fixed IC.
- STOCK:** Matte black-finished walnut (black synthetic on 12-gauge models).
- TRIGGER:** Single trigger.
- SIGHTS:** Fiber-optic front sight.

## Condor Longfowler, Condor Supreme and Condor Field

Elegant and affordable



**CONDOR FIELD – 12-GA, 3"**  
ITEM # 31441 Black synthetic

12-gauge model stocks are now available in your choice of Walnut grades, or in a new black synthetic, weather-resistant textured version to ensure a solid grip in foul weather.



**CONDOR SUPREME – 12-GA, 3"**  
AA-Grade gloss walnut



The Stoeger Condor Supreme comes with auto-ejectors for quick ejection of empty hulls and faster reloading of fresh shells.

### STANDARD FEATURES

**CHOKE TUBES:** IC and M (.410 F and F fixed).  
**STOCK:** A-Grade satin walnut, Black synthetic on model 31441, (Supreme models AA-Grade gloss walnut).  
**TRIGGER:** Single trigger (Supreme models single-selective trigger).  
**SIGHTS:** Brass bead.

### OPTIONAL FEATURES

**CHOKE TUBES:** Flush and Extended C, IC, M, IM and F (12- and 20-gauge only).



**CONDOR LONGFOWLER – 12-GA, 3"**  
ITEM # 31061 A-Grade satin walnut

Stoeger's Condor Longfowler is a 12-gauge over/under featuring a 30-inch barrel and extended choke tubes. Designed with waterfowlers in mind, this is a shotgun that's balanced right for a smooth, steady swing when it counts. Here's a waterfowl gun that will work as hard as you do, without blowing the budget.



**CONDOR FIELD COMPACT – 20-GA OR .410, 3"**  
ITEM # 31036 A-Grade satin walnut

A perfect fit for beginners and small-statured adults, the Condor Field Compact model comes with all the standard features of a full-size Condor. It features a 22-inch barrels and a 13-inch length of pull.

CONDOR SUPREME						
ITEM NUMBER	BARREL LENGTH	STOCK	CHOKES	OVERALL LENGTH	AVERAGE WEIGHT	MSRP
<b>12-GAUGE 2 3/4" AND 3"</b>						
31005	28"	AA-Grade	Screw-in	44"	7.6 lbs.	\$599

COMMON SPECIFICATIONS: **Trigger:** Single-Selective Trigger **Chokes:** IC & M **Type of Sights:** Brass Bead with Mid-Bead **Length of Pull:** 14 1/2" **Drop at Heel:** 2 1/2" **Drop at Comb:** 1 1/2" **Automatic Ejectors**

CONDOR LONGFOWLER						
ITEM NUMBER	BARREL LENGTH	STOCK	EXTENDED CHOKES	OVERALL LENGTH	AVERAGE WEIGHT	MSRP
<b>12-GAUGE 2 3/4" AND 3"</b>						
31061	30"	A-Grade	Screw-in	46"	8.1 lbs.	\$499
<b>20-GAUGE 2 3/4" AND 3"</b>						
31064	30"	A-Grade	Screw-in	46"	7.0 lbs.	\$499

COMMON SPECIFICATIONS: **Trigger:** Single Trigger **Chokes:** Extended IC & M **Type of Sights:** Brass Bead **Length of Pull:** 14 1/2" **Drop at Heel:** 2 1/2" **Drop at Comb:** 1 1/2" **Shell Extractor**

SPECIFICATIONS AND PRICES SUBJECT TO CHANGE WITHOUT NOTICE.

CONDOR FIELD & COMBO						
ITEM NUMBER	BARREL LENGTH	STOCK	CHOKES	OVERALL LENGTH	AVERAGE WEIGHT	MSRP
<b>12-GAUGE 2 3/4" AND 3"</b>						
31441	28"	Black synthetic	Screw-in	44"	7.3 lbs.	\$329
31025	26"	A-Grade	Screw-in	42"	7.3 lbs.	\$499
31030	28"	A-Grade	Screw-in	44"	7.4 lbs.	\$499
<b>20-GAUGE 2 3/4" AND 3"</b>						
31035	26"	A-Grade	Screw-in	42"	6.8 lbs.	\$499
31040	28"	A-Grade	Screw-in	44"	6.9 lbs.	\$499
<b>28-GAUGE 2 3/4"</b>						
31031	26"	A-Grade	Screw-in	42"	6.0 lbs.	\$499
<b>.410-GAUGE 2 1/2" AND 3"</b>						
31042	26"	A-Grade	Fixed	42"	6.0 lbs.	\$499
<b>20-GAUGE COMPACT (13" LOP) 2 3/4" AND 3"</b>						
31036	22"	A-Grade	Screw-in	36.5"	5.5 lbs.	\$499
<b>.410-GAUGE COMPACT (13" LOP) 2 1/2" AND 3"</b>						
31037	22"	A-Grade	Fixed	36.5"	5.5 lbs.	\$499

COMMON SPECIFICATIONS: **Trigger:** Single Trigger **Chokes:** IC & M (.410 models have fixed F & F chokes) **Type of Sights:** Brass Bead **Length of Pull:** 14 1/2" (Youth 13") **Drop at Heel:** 2 1/2" **Drop at Comb:** 1 1/2" **Shell Extractor**

## Condor Outback

Simplicity and versatility

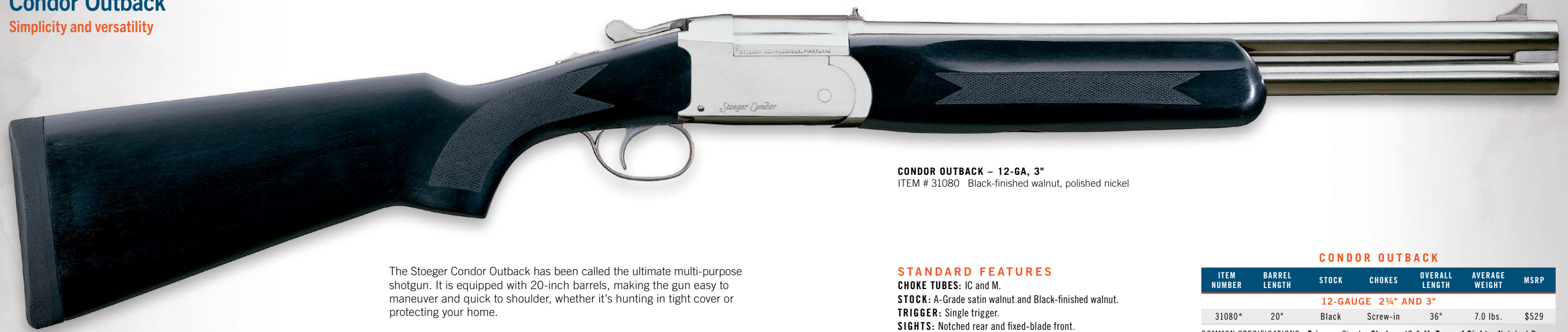

**CONDOR OUTBACK – 12-GA, 3"**  
ITEM # 31080 Black-finished walnut, polished nickel

The Stoeger Condor Outback has been called the ultimate multi-purpose shotgun. It is equipped with 20-inch barrels, making the gun easy to maneuver and quick to shoulder, whether it's hunting in tight cover or protecting your home.

### STANDARD FEATURES

**CHOKE TUBES:** IC and M.  
**STOCK:** A-Grade satin walnut and Black-finished walnut.  
**TRIGGER:** Single trigger.  
**SIGHTS:** Notched rear and fixed-blade front.

### OPTIONAL FEATURES

**CHOKE TUBES:** Flush and extended C, IC, M, IM and F.

### CONDOR OUTBACK

ITEM NUMBER	BARREL LENGTH	STOCK	CHOKES	OVERALL LENGTH	AVERAGE WEIGHT	MSRP
<b>12-GAUGE 2 3/4" AND 3"</b>						
31080*	20"	Black	Screw-in	36"	7.0 lbs.	\$529

COMMON SPECIFICATIONS: **Trigger:** Single **Chokes:** IC & M **Type of Sights:** Notched Rear and Fixed-Blade Front **Length of Pull:** 14 1/2" **Drop at Heel:** 2 1/2" **Drop at Comb:** 1 1/2" **Shell Extractor** \*Polished nickel finish with black-finished walnut stock and forend

## Condor Competition

From range to field



**CONDOR COMPETITION – 12-GA, 3"**  
ITEM # 31045 AA-Grade gloss walnut

Ported barrels come standard on the Condor Competition. Barrel porting lets gas escape through the top of the barrel to help keep barrel climb to a minimum for a quick second shot.

The Condor Competition is equally at home on a sporting clays course, skeet field or trap range. Available in 12- or 20-gauge, the Condor Competition features ported barrels, automatic ejectors and an adjustable comb.

### CONDOR COMPETITION

ITEM NUMBER	BARREL LENGTH	STOCK	CHOKES	OVERALL LENGTH	AVERAGE WEIGHT	MSRP
<b>12-GAUGE 2 3/4" AND 3"</b>						
31045	30"	AA-Grade	Screw-in	47"	8.85 lbs.	\$699

COMMON SPECIFICATIONS: **Trigger:** Single Selective Trigger **Extended Chokes:** IC, M, F (2 ea.) **Type of Sights:** Brass Bead with silver mid-bead **Length of Pull:** 14 1/2" **Drop at Heel:** 2 1/2" **Drop at Comb:** Adjustable **Barrel:** Ported **Automatic Ejector**

SPECIFICATIONS AND PRICES SUBJECT TO CHANGE WITHOUT NOTICE.

### STANDARD FEATURES

**CHOKE TUBES:** Extended IC, M, F (2 each) and wrench.  
**STOCK:** AA-Grade gloss walnut. Right-hand palm swell on grip and stock with fully adjustable comb.  
**SIGHTS:** Brass bead and silver mid-bead.  
**BARRELS:** Ported 30" barrels.

### OPTIONAL FEATURES

**CHOKE TUBES:** Flush and Extended C, IC, M, IM and F.



The fully adjustable comb on the Condor Competition allows you to custom fit the stock to your personal stock dimensions for whatever target game you favor.



A distinctive palm swell for right-handed shooters gives the Condor Competition a real custom feel. You'll swear the Condor Competition was made for you.



# The Grand

Target-smashing efficiency



**THE GRAND – 12-GA, 3"**  
ITEM # 31675 A-Grade satin walnut

The Grand is an entry-level target gun designed for shooting trap. It features a single 30-inch barrel with a stepped ventilated rib and fiber-optic front sight to get on target quickly. The stock incorporates an adjustable comb for a personalized fit.

**STANDARD FEATURES**

**CHOKE TUBES:** Extended M, IM, F and wrench.  
**STOCK:** A-Grade satin walnut. Fully adjustable comb.  
**SIGHTS:** Red fiber-optic front sight.  
**BARRELS:** 30" barrel with wide trap rib.

**OPTIONAL FEATURES**

**CHOKE TUBES:** Flush and Extended C, IC, M, IM and F.

**THE GRAND**

ITEM NUMBER	BARREL LENGTH	STOCK	EXTENDED CHOKES	OVERALL LENGTH	AVERAGE WEIGHT	MSRP
<b>12-GAUGE 2¾" AND 3"</b>						
31675	30"	A-Grade	Screw-in	46"	9.1 lbs.	\$679

COMMON SPECIFICATIONS: **Extended Chokes:** M, IM, F **Type of Sights:** Red fiber-optic front sight **Length of Pull:** 14½" **Drop at Heel:** 2½" **Drop at Comb:** Adjustable **Extractor**

SPECIFICATIONS AND PRICES SUBJECT TO CHANGE WITHOUT NOTICE.



The fully adjustable comb on the Grand allows you to custom fit the stock to match your personal stock requirements.



The Grand's single barrel features an extractor that lifts the shell from the chamber.

## Uplander Longfowler, Uplander Supreme and Uplander

Timeless and affordable

**UPLANDER LONGFOWLER — 12-GA, 3"**  
ITEM # 31062 A-Grade satin walnut



Stoeger's Uplander Longfowler is a classic "duck gun" with the swing, balance and look of a traditional side-by-side shotgun. Designed with waterfowlers in mind, 30-inch barrels and extended choke tubes gives the Longfowler excellent balance for a smooth swing and the ability to really reach out.

**UPLANDER SUPREME — 12-GA, 3"**  
AA-Grade gloss walnut

The Uplander Supreme is the ultimate refinement of the Uplander. With a single gold-plated trigger, interchangeable choke tubes and a checkered AA-grade American walnut stock, it's an exciting combination of features and low price.

**UPLANDER — 28-GA, 2¾"**  
ITEM # 31190 A-Grade satin walnut

The Stoeger Uplander 28-gauge is perfect for small-game hunting. The lightweight design won't strain your body during all-day hunts in the field, so you are always ready for that next shot. For hunters and sportsmen looking for more of a challenge but still wanting to have fun shooting, the 28-gauge will suit your needs.

**UPLANDER COMPACT — .410, 3"**  
ITEM # 31135 A-Grade satin walnut

The Uplander Compact model is an excellent choice for beginner shooters and small-statured adults. The short stock allows the opportunity for more hunters and shooters to enjoy the history and style of the classic side-by-side design.

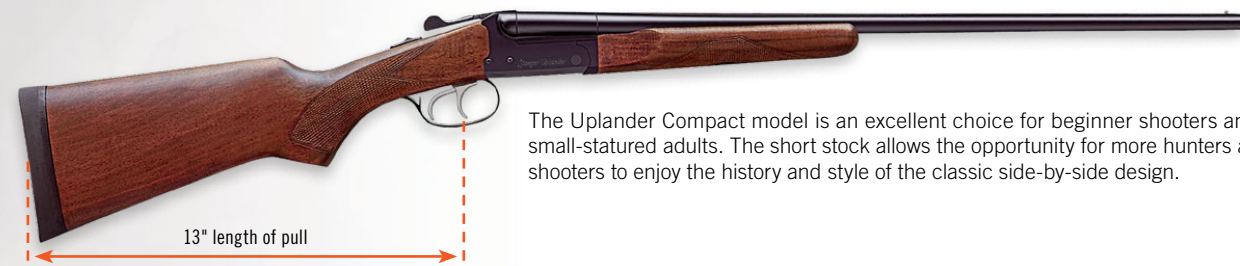
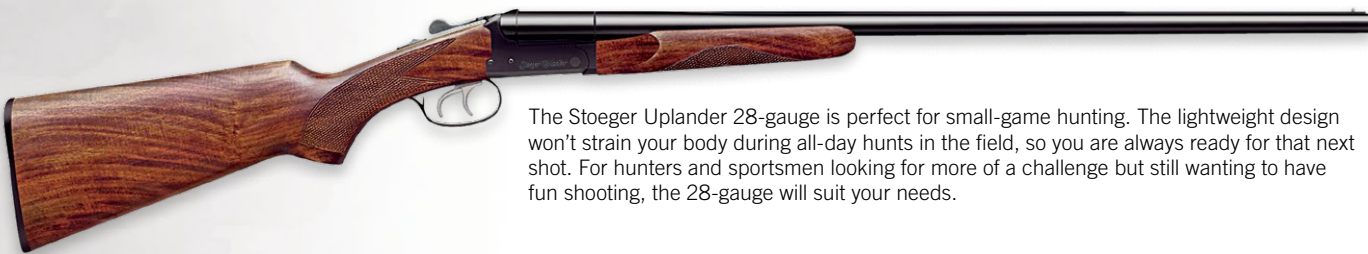

**STANDARD FEATURES**

**CHOKE TUBES:** IC and M 12-ga. and 20-ga. (28-ga. IC and M fixed, .410: F and F fixed).  
**STOCK:** A-Grade satin walnut (Supreme models AA-Grade gloss walnut).  
**SIGHTS:** Brass bead.

**OPTIONAL FEATURES**

**CHOKE TUBES:** Both flush and extended chokes available in C, IC, M, IM and F (12- and 20-gauge only).



Depending on the model, Uplanders come with either a single trigger or sturdy traditional double triggers for optimum reliability.



All of Stoeger's Uplander side-by-side models come standard with extractors.



Uplanders feature a tang-mounted safety, which is automatically engaged when the gun is broken open.



The receiver is precision-machined to exacting tolerances to ensure the Uplander will hold up year-after-year.

**UPLANDER SUPREME**

ITEM NUMBER	BARREL LENGTH	STOCK	CHOKES	OVERALL LENGTH	AVERAGE WEIGHT	MSRP
<b>12-GAUGE 2¾" AND 3"</b>						
31105	28"	AA-Grade	Screw-in	44"	7.5 lbs.	\$599

COMMON SPECIFICATIONS: **Trigger:** Single Trigger **Chokes:** IC & M **Type of Sights:** Brass Bead **Length of Pull:** 14½" (Youth 13") **Drop at Heel:** 2½" **Drop at Comb:** 1½" **Shell Extractor**

**UPLANDER LONGFOWLER**

ITEM NUMBER	BARREL LENGTH	STOCK	EXTENDED CHOKES	OVERALL LENGTH	AVERAGE WEIGHT	MSRP
<b>12-GAUGE 2¾" AND 3"</b>						
31062	30"	A-Grade	Screw-in	46"	7.6 lbs.	\$499

COMMON SPECIFICATIONS: **Trigger:** Single Trigger **Chokes:** Extended IC & M **Type of Sights:** Brass Bead **Length of Pull:** 14½" **Drop at Heel:** 2½" **Drop at Comb:** 1½" **Shell Extractor**

SPECIFICATIONS AND PRICES SUBJECT TO CHANGE WITHOUT NOTICE.

**UPLANDER**

ITEM NUMBER	BARREL LENGTH	STOCK	CHOKES	OVERALL LENGTH	AVERAGE WEIGHT	MSRP
<b>12-GAUGE 2¾" AND 3"</b>						
31140	26"	A-Grade	Screw-in	42"	7.4 lbs.	\$499
31145	28"	A-Grade	Screw-in	44"	7.5 lbs.	\$499

<b>20-GAUGE 2¾" AND 3"</b>						
31150	26"	A-Grade	Screw-in	42"	7.3 lbs.	\$499

<b>28-GAUGE 2¾"</b>						
31190	26"	A-Grade	Fixed	42"	7.1 lbs.	\$499

<b>.410-GAUGE 2½" AND 3"</b>						
31195	26"	A-Grade	Fixed	42"	7.0 lbs.	\$499

<b>.410-GAUGE COMPACT (13" LOP) 2½" AND 3"</b>						
31135	22"	A-Grade	Fixed	36.5"	6.5 lbs.	\$499

COMMON SPECIFICATIONS: **Trigger:** Double Trigger **Chokes:** IC & M (28-ga. fixed chokes are IC & M, .410 fixed chokes are F & F) **Type of Sights:** Brass Bead **Length of Pull:** 14½" (Youth 13") **Drop at Heel:** 2½" **Drop at Comb:** 1½" **Shell Extractor**

## Coach Gun and Coach Gun Supreme

The choice of cowboy action shooters

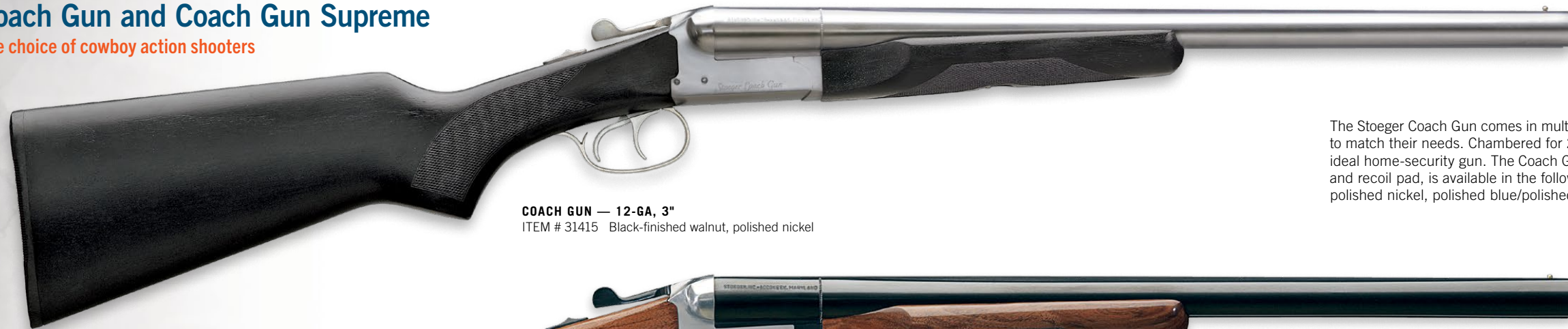

**COACH GUN — 12-GA, 3"**  
ITEM # 31415 Black-finished walnut, polished nickel



**COACH GUN SUPREME WITH SINGLE TRIGGER — 12-GA, 3"**  
ITEM # 31463 AA-Grade gloss walnut, stainless receiver, polished-blue barrels



**COACH GUN — .410, 3"**  
ITEM # 31410 A-Grade satin walnut, polished blue



**COACH GUN WITH SINGLE TRIGGER — 12-GA, 3"**  
ITEM # 31460 A-Grade satin walnut, polished blue



**COACH GUN SUPREME — 12-GA, 3"**  
ITEM # 31482 AA-Grade gloss walnut, polished nickel



**COACH GUN SUPREME — 12-GA, 3"**  
ITEM # 31483 AA-Grade gloss walnut, stainless receiver, polished blue barrels



**COACH GUN SUPREME — 12-GA, 3"**  
ITEM # 31481 AA-Grade gloss walnut, polished blue

An attractive trigger guard gives the Coach Gun and Coach Gun Supreme a more refined appearance, with smooth curves that complement the triggers.



### STANDARD FEATURES

- CHOKE:** IC and M fixed.
- STOCK:** A-Grade satin walnut or Black-finished walnut.
- SIGHTS:** Brass bead.

### COACH GUNS

ITEM NUMBER	BARREL LENGTH	STOCK	GAUGE	OVERALL LENGTH	AVERAGE WEIGHT	MSRP
<b>SATIN WALNUT, BLUE 2 3/4" AND 3" (.410 2 1/2", AND 3")</b>						
31400	20"	A-Grade	12	36.5"	6.5 lbs.	\$499
31405	20"	A-Grade	20	36.5"	6.4 lbs.	\$499
31410	20"	A-Grade	.410	36.5"	6.3 lbs.	\$499
31460*	20"	A-Grade	12	36.5"	6.5 lbs.	\$499
31461*	20"	A-Grade	20	36.5"	6.4 lbs.	\$499
<b>BLACK-FINISHED HARDWOOD, POLISHED NICKEL 2 3/4" AND 3"</b>						
31415	20"	Black	12	36.5"	6.5 lbs.	\$599

COMMON SPECIFICATIONS: **Trigger:** Double (except where noted with \*) **Chokes:** Fixed IC & M (.410 fixed F & F) **Type of Sights:** Brass bead **Length of Pull:** 14 1/2" **Drop at Heel:** 2 1/2" **Drop at Comb:** 1 1/2" **Shell Extractor** \*Single-trigger model

SPECIFICATIONS AND PRICES SUBJECT TO CHANGE WITHOUT NOTICE.

The Stoeger Coach Gun comes in multiple finishes allowing competitors in Cowboy Action Shooting to match their needs. Chambered for 2 3/4-inch and 3-inch shells, the Coach Gun also makes an ideal home-security gun. The Coach Gun Supreme, which comes with an upgraded walnut stock and recoil pad, is available in the following barrel/receiver finish combinations: polished nickel/polished nickel, polished blue/polished blue and stainless/polished blue.



The 12- and 20-gauge Coach Gun Supremes come with improved cylinder and modified choke tubes and wrench.

### STANDARD FEATURES

- CHOKE TUBES:** IC and M.
- STOCK:** AA-Grade gloss walnut.
- SIGHTS:** Brass bead.



Stoeger's Single-Trigger Coach guns feature a gold-plated single trigger for quick follow-up shots.

### OPTIONAL FEATURES

- CHOKE TUBES:** Flush and Extended C, IC, M, IM and F.

### COACH GUN SUPREME

ITEM NUMBER	BARREL LENGTH	STOCK	GAUGE	OVERALL LENGTH	AVERAGE WEIGHT	MSRP
<b>GLOSS WALNUT, BLUE 2 3/4" AND 3"</b>						
31481	20"	AA-Grade	12	36.5"	6.5 lbs.	\$599
<b>GLOSS WALNUT, BLUE/STAINLESS RECEIVER 2 3/4" AND 3"</b>						
31483	20"	AA-Grade	12	36.5"	6.5 lbs.	\$599
31463*	20"	AA-Grade	12	36.5"	6.5 lbs.	\$599
31462*	20"	AA-Grade	20	36.5"	6.4 lbs.	\$599
<b>GLOSS WALNUT, POLISHED NICKEL 2 3/4" AND 3"</b>						
31482	20"	AA-Grade	12	36.5"	6.5 lbs.	\$599
31489	20"	AA-Grade	20	36.5"	6.4 lbs.	\$599

COMMON SPECIFICATIONS: **Trigger:** Double (except where noted with \*) **Chokes:** Screw-in IC & M **Type of Sights:** Brass bead **Length of Pull:** 14 1/2" **Drop at Heel:** 2 1/2" **Drop at Comb:** 1 1/2" **Shell Extractor** \*Single-trigger model

Accessories

Gun cases, stocks & more



ITEM # 94210  
Black \$35



ITEM # 94201  
Max-7™ \$45



ITEM # 94205  
Bottomland™ \$45

STOEGER SOFT GUN CASES

Branded soft gun cases protect your shotgun during transport to and from the field or range. Choose from three durable options: Max-7™, Bottomland™ or black.



STOEGER PISTOL CASE

Securely transport your pistols to and from the range with Stoeger's 2-Gun Pistol Case. Constructed of 600D PVC-backed fabric, this case features two zippered gun storage pockets, five magazine holders, and two front accessory pockets to optimize organization. Measures 13" W x 8.5" H x 2.75" D.



ITEM # 94215  
Black \$30



M3500 RECOIL REDUCER

Installing the optional recoil reducer in a new camo or synthetic Model 3500 adds recoil-mitigating weight to the stock. The buttstock incorporates a cut cavity that facilitates easy installation, and removal is a snap when firing lighter loads.

CASES

ITEM NUMBER	DESCRIPTION	MSRP
94210	Stoeger Soft Gun Case - Black, 52"	\$35
94201	Stoeger Floater Soft Gun Case - Realtree® MAX-7™, 52"	\$45
94205	Stoeger Floater Soft Gun Case - Mossy Oak® Bottomland™, 52"	\$45
94215	Stoeger Pistol Case	\$30

ACCESSORIES

ITEM NUMBER	DESCRIPTION	MSRP
33490	Recoil Reducer for M3500	\$60

## Stoeger T-shirts and Hoodies



ITEM # 95250  
Dark Gray \$70

Generously cut heavyweight hoodie with brushed exterior and extra soft interior, constructed from 11 oz. 75% Cotton/25% Poly-blend fabric. Specify size when ordering: sizes S - XXL



**NEW** ITEM # 95202  
Olive \$30

A more modern fit tee. Constructed from 4.3 oz., 40% Poly / 60% Cotton-blend fabric. Specify size when ordering: sizes S - XXXL



**NEW** ITEM # 95203  
Black \$30

A more modern fit tee. Constructed from 4.3 oz., 40% Poly / 60% Cotton-blend fabric. Specify size when ordering: sizes S - XXXL



ITEM # 95200  
Charcoal \$25

Classic-styled garment, constructed from 5.4 oz., 100% cotton fabric. Specify size when ordering: sizes S - XXL



ITEM # 95201  
Oxford \$25

Classic-styled garment, constructed from 5.4 oz., 100% cotton fabric. Specify size when ordering: sizes S - XXL

## Stoeger Hats



ITEM # 91257  
Vintage Timber & Black Mesh \$25



ITEM # 91258  
Black & Gray Mesh \$25



ITEM # 91259  
Max-7™ \$25



ITEM # 91260  
Bottomland™ \$25



ITEM # 91253  
Blue \$25



ITEM # 91251  
Blaze \$25



ITEM # 91256  
Vintage Marsh \$25

### APPAREL

ITEM NUMBER	DESCRIPTION	MSRP
91251	Stoeger Logo Hat, Blaze Orange	\$25
91256	Stoeger Patch Hat, Vintage Marsh and Brown Mesh	\$25
91259	Stoeger Logo Hat, Realtree® MAX-7™ and Khaki Mesh	\$25
91260	Stoeger Logo Hat, Mossy Oak® Bottomland™ and Khaki Mesh	\$25
91253	Stoeger Vintage Hat, Faded Blue & Sand Mesh	\$25
91257	Stoeger Patch Hat, Vintage Marsh & Brown Mesh	\$25
91258	Stoeger Logo Hat, Faded Black & Gray Mesh	\$25
95200 S-XXL	Stoeger Logo T-shirt	\$25
95201 S-XXL	Stoeger Freedom Series T-shirt	\$25
95250 S-XXL	Stoeger Heavyweight Vintage Logo Heavy	\$70
<b>NEW</b> 95202 S-XXXL	Vintage Logo T-Shirt, Olive	\$30
<b>NEW</b> 95203 S-XXXL	Stoeger Game Shield T-Shirt, Black	\$30



## 2024 Authorized Commercial Dealer Price List

AUTHORIZED DEALER TOLL FREE NUMBER: 800-264-4962 FAX: 301-283-6988

STOEGER FIREARMS – EFFECTIVE JANUARY 1, 2024

Specifications and Prices Subject to Change Without Notice.

This price supersedes all previously issued price lists.

Item Number	Barrel Length	Description	Gauge / Caliber	Magazine Capacity	UPC Code	MSRP
<b>STR MICRO-COMPACT PISTOL (polymer frame, striker-fired)</b>						
31766	3.29"	Black, 2 mags, standard sights	9 mm	13+1	037084317663	\$399
31768	3.29"	Black, 2 mags, standard sights	9 mm	10+1	037084317687	\$399
31770	3.29"	Black, 3 mags, optic ready, night sights	9 mm	13+1	037084317700	\$479
31771	3.29"	Black, 3 mags, optic ready, night sights	9 mm	10+1	037084317717	\$479
<b>STR SUB-COMPACT PISTOL (polymer frame, striker-fired)</b>						
31750	3.54"	Black, 1 magazine, 1 backstrap (M)	9 mm	10+1	037084317502	\$329
31792	3.54"	Black, 2 mags., 3 backstrap, optic ready	9 mm	10+1	037084317922	\$399
<b>STR COMPACT PISTOL (polymer frame, striker-fired)</b>						
31730	3.8"	Black, 1 magazine, 1 backstrap (M)	9 mm	13+1	037084317304	\$329
31733	3.8"	Black, 1 magazine, 1 backstrap (M)	9 mm	10+1	037084317335	\$329
31788	3.8"	Black, 2 mags., 3 backstraps, optic ready	9 mm	13+1	037084317885	\$399
31789	3.8"	Black, 2 mags., 3 backstraps, optic ready	9 mm	10+1	037084317892	\$399
<b>STR PISTOL (polymer frame, striker-fired)</b>						
31720	4.17"	Black, 1 magazine, 1 backstrap (M)	9 mm	15+1	037084317205	\$329
31724	4.17"	Black, 1 magazine, 1 backstrap (M)	9 mm	10+1	037084317243	\$329
31782	4.17"	Black, 2 mags., 3 backstraps, optic ready	9 mm	15+1	037084317823	\$429
31783	4.17"	Black, 2 mags., 3 backstraps, optic ready	9 mm	10+1	037084317830	\$399
NEW 317A27	4.17"	FDE Distressed, 2 mags., 3 backstraps, optic ready	9 mm	10+1	037084968124	\$499
NEW 317A25	4.17"	Meprolight, 2 mags., 3 backstraps	9 mm	10+1	037084968100	\$549
NEW 317A24	4.17"	Meprolight, 2 mags., 3 backstraps	9 mm	15+1	037084968094	\$549
NEW 317A26	4.17"	FDE Distressed, 2 mags., 3 backstraps, optic ready	9 mm	15+1	037084968100	\$499
NEW 317A22	4.17"	FDE, 2 mags., 3 backstraps, F.O. sights	9 mm	15+1	037084968070	\$549
NEW 317A20	4.17"	OD Green, 2 mags., 3 backstraps, F.O. sights	9 mm	15+1	037084968056	\$549
NEW 317A21	4.17"	OD Green, 2 mags., 3 backstraps, F.O. sights	9 mm	10+1	037084968063	\$549
31767	4.17"	Black, 1 magazine, standard sights	40	11+1	037084317670	\$329

Item Number	Barrel Length	Description	Gauge / Caliber	Magazine Capacity	UPC Code	MSRP	
<b>STR FULL SIZE PISTOL (polymer frame, striker-fired)</b>							
	31752	4.68"	Black, 1 magazine, 1 backstrap (M)	9 mm	17+1	037084317526	\$329
	31762	4.68"	Black, 1 magazine, 1 backstrap (M)	9 mm	10+1	037084317625	\$329
	31794	4.68"	Black, 2 mags., 3 backstrap, F.O. sights	9 mm	20+1	037084317946	\$629
NEW	31799	5.18"	Black, 2 mags., 2 backstrap, F.O. sights	45 ACP	10+1	037084317991	\$529
NEW	31798	5.18"	Black, 2 mags., 2 backstrap, F.O. sights	45 ACP	13+1	037084317984	\$529
NEW	31797	5.18"	Black, 2 mags., 3 backstrap, Optic ready	45 ACP	10+1	037084317977	\$449
NEW	31796	5.18"	Black, 2 mags., 3 backstrap, F.O. sights	45 ACP	13+1	037084317960	\$449
<b>STR COMBAT PISTOL (polymer frame, striker-fired, threaded barrel, optic ready)</b>							
	31736	4.67"	Black, 3 mags., 3 backstraps, F.O. sights	9 mm	20+1	037084317366	\$629
NEW	31776	4.17"	Black, 3 magazines, 3 backstraps	9 mm	10+1	037084317762	\$599
NEW	31775	4.17"	Black, 3 magazines, 3 backstraps	9 mm	17+1	037084317755	\$599
	31786	4.17"	Black, 3 mags., 3 backstraps, tungsten cerakote, F.O. sights, with hard case	9 mm	20+1	037084317861	\$679
<b>MODEL 3500 (with patented Inertia System)</b>				<b>2¾", 3" and 3½" (screw-in chokes)</b>			
	36054	28"	Realtree® Max-7™	12	4+1	037084360546	\$799
	36035	26"	Realtree® Max-7™	12	4+1	037084360355	\$799
	36005	28"	Mossy Oak® Bottomland™	12	4+1	037084360058	\$799
	36049	28"	Realtree® Max-7™, Bronze Cerakote	12	4+1	037084360492	\$849
	36024	28"	Black synthetic	12	4+1	037084360249	\$699
	36009	26"	Black synthetic	12	4+1	037084360096	\$699
<b>MODEL 3500 SNOW GOOSE FREEDOM SERIES (with Inertia System)</b>				<b>2¾", 3" and 3½" (screw-in chokes)</b>			
	36014FS	28"	Distressed White Cerakote	12	10+1	037084967554	\$979
<b>MODEL 3500 PREDATOR/TURKEY SPECIAL (with Inertia System)</b>				<b>2¾", 3" and 3½" (screw-in chokes)</b>			
NEW	36037	24"	Mossy Oak® Overwatch™	12	4+1	037084360379	\$979
<b>MODEL 3500 WATERFOWL SPECIAL (with patented Inertia System)</b>				<b>2¾", 3" and 3½" (screw-in chokes)</b>			
	36000	28"	Realtree® Max-7™, Flat Dark Earth Cerakote	12	4+1	037084360003	\$899
<b>MODEL 3000 SIGNATURE (with patented Inertia System)</b>				<b>2¾", 3" and 3½" (screw-in chokes)</b>			
NEW	36064	28"	Satin walnut, Engraved Gray Cerakote	12	4+1	037084360645	\$799
<b>MODEL 3000 (with patented Inertia System)</b>				<b>2¾" and 3" (screw-in chokes)</b>			
	36020	28"	Satin walnut, polished blue	12	4+1	037084360201	\$649
	36052	28"	Satin walnut, Burnt Bronze Cerakote	12	4+1	037084360522	\$699
	36016	28"	Black synthetic	12	4+1	037084360164	\$599
	36018	26"	Black synthetic	12	4+1	037084360188	\$599
	36023	26"	Realtree® Max-7™	12	4+1	037084360232	\$649
	36017	28"	Realtree® Max-7™	12	4+1	037084360171	\$649
	36006	26"	Mossy Oak® Bottomland™	12	4+1	037084360065	\$649
	36045	28"	Realtree® Max-7™, Bronze Cerakote	12	4+1	037084360454	\$699
	36015	28"	Mossy Oak® Bottomland™	12	4+1	037084318578	\$649
NEW	36039	18.5"	Black synthetic, pistol grip	12	4+1	037084318578	\$649
NEW	36063	28"	Black synthetic, Left-handed	12	4+1	037084360638	\$599

PRICE LIST

Item Number	Barrel Length	Description	Gauge / Caliber	Magazine Capacity	UPC Code	MSRP
<b>MODEL 3000 COMPACT (with patented Inertia System)</b>				<b>2¾" and 3" (screw-in chokes)</b>		
NEW 36036	26"	Black synthetic	12	4+1	037084360362	\$599
<b>MODEL 3000R RIFLED SLUG (with patented Inertia System)</b>				<b>2¾" and 3" (rifled barrel)</b>		
36031	24"	Black synthetic	12	4+1	037084360317	\$649
<b>MODEL 3000 M3K 3GUN (with patented Inertia System)</b>				<b>2¾" and 3" (screw-in chokes)</b>		
36038	24"	Black synthetic	12	4+1	037084360386	\$699
<b>MODEL 3000 M3K 3GUN FREEDOM SERIES (with Inertia System)</b>				<b>2¾" and 3" (screw-in chokes)</b>		
36038FS	24"	Black synthetic (10 round extended mag tube)	12	10+1	037084967561	\$749
<b>MODEL 3000 SPORTING (with patented Inertia System)</b>				<b>2¾" and 3" (screw-in chokes)</b>		
36034	30"	Black synthetic	12	4+1	037084360348	\$699
<b>MODEL 3000 DEFENSE FREEDOM SERIES (with Inertia System)</b>				<b>2¾" and 3" (fixed cylinder choke)</b>		
31891FS	18.5"	Black synthetic Pistol Grip (7-round ext. mag tube)	12	7+1	037084960241	\$699
36033FS	18.5"	Black synthetic (7-round ext. mag tube)	12	7+1	037084967547	\$649
<b>MODEL 3020 (with patented Inertia System)</b>				<b>2¾" and 3" (screw-in chokes)</b>		
36001	28"	Realtree® Max-7™	20	4+1	037084360010	\$649
36004	26"	Mossy Oak® Bottomland™	20	4+1	037084360041	\$649
36007	26"	Black synthetic	20	4+1	037084360072	\$599
36010	28"	Black synthetic	20	4+1	037084360102	\$599
36012	28"	Satin walnut, Burnt Bronze Cerakote	20	4+1	037084360126	\$699
36002	28"	Realtree® Max-7™, Burnt Bronze Cerakote	20	4+1	037084360027	\$699
36030	24"	Mossy Oak® Obsession™ (Ghost-ring sights)	20	4+1	037084360300	\$649
<b>MODEL 3020 UPLAND SUPREME (with patented Inertia System)</b>				<b>2¾" and 3" (screw-in chokes)</b>		
36011	26"	Anodized silver receiver, Satin walnut	20	4+1	037084360119	\$699
<b>MODEL 3020 COMPACT (with patented Inertia System)</b>				<b>2¾" and 3" (screw-in chokes)</b>		
NEW 36003	26"	Black synthetic	20	4+1	037084360034	\$599
<b>P3000 PUMP SHOTGUN</b>				<b>2¾" and 3" (screw-in chokes)</b>		
31856	28"	Black synthetic	12	5+1	037084318561	\$329
31861	26"	Black synthetic	12	5+1	037084318615	\$329
36056	28"	Realtree® Max-7™	12	5+1	037084360560	\$399
36057	26"	Realtree® Max-7™	12	5+1	037084360577	\$399
31921	28"	Satin walnut	12	5+1	037084319216	\$399
<b>P3000 DEFENSE PUMP SHOTGUN FREEDOM SERIES SUPREME</b>				<b>2¾" and 3" (fixed cylinder choke)</b>		
31894FS	18.5"	Black synth. (folding stock, 7-rnd. ext. mag)	12	7+1	037084961859	\$529
<b>P3000 DEFENSE PUMP SHOTGUN FREEDOM SERIES</b>				<b>2¾" and 3" (fixed cylinder choke)</b>		
31892FS	18.5"	Black synthetic (7-round ext. mag tube)	12	7+1	037084960258	\$399
<b>P3000 DEFENSE PUMP SHOTGUN</b>				<b>2¾" and 3" (fixed cylinder choke)</b>		
31892	18.5"	Black synthetic	12	5+1	037084318929	\$329
31893	18.5"	Black synthetic Pistol Grip	12	5+1	037084318936	\$399
<b>P3500 PUMP SHOTGUN</b>				<b>2¾", 3" and 3½" (screw-in chokes)</b>		
31880	28"	Black synthetic	12	4+1	037084318806	\$399
31881	26"	Black synthetic	12	4+1	037084318813	\$399
36058	26"	Realtree® Max-7™	12	4+1	037084360584	\$449
36059	28"	Realtree® Max-7™	12	4+1	037084360591	\$449



Item Number	Barrel Length	Description	Gauge / Caliber	Magazine Capacity	UPC Code	MSRP
<b>CONDOR FIELD (ST-EXT)</b>			<b>2¾" and 3" (screw-in chokes)</b>			
31441	28"	O/U, Black synthetic	12		037084314419	\$329
31025	26"	O/U, A-Grade satin walnut	12		037084310251	\$499
31030	28"	O/U, A-Grade satin walnut	12		037084310305	\$499
31035	26"	O/U, A-Grade satin walnut	20		037084310350	\$499
31040	28"	O/U, A-Grade satin walnut	20		037084310404	\$499
31031	26"	O/U, A-Grade satin walnut (2¾" only)	28		037084310312	\$499
31042	26"	O/U, A-Grade satin walnut	.410	(fixed F & F)	037084310428	\$499
<b>CONDOR COMPACT (ST-EXT) 13" L.O.P.</b>			<b>2¾" and 3"</b>			
31036	22"	O/U, A-Grade satin walnut	20	(screw-in)	037084310367	\$499
31037	22"	O/U, A-Grade satin walnut	.410	(fixed F & F)	037084310374	\$499
<b>CONDOR COMPETITION (SST-AE)</b>			<b>2¾" and 3" (screw-in chokes)</b>			
31045	30"	O/U, AA-Grade gloss walnut RH, ported	12		037084310459	\$699
<b>CONDOR SUPREME (SST-AE)</b>			<b>2¾" and 3" (screw-in chokes)</b>			
31005	28"	O/U, AA-Grade gloss walnut	12		037084310053	\$599
<b>CONDOR OUTBACK (ST-EXT)</b>			<b>2¾" and 3" (screw-in chokes)</b>			
31080	20"	O/U, Black finished walnut / polished nickel	12		037084310800	\$529
<b>CONDOR LONGFOWLER (ST-EXT)</b>			<b>2¾" and 3" (screw-in chokes)</b>			
31061	30"	O/U, A-Grade satin walnut	12		037084310619	\$499
31064	30"	O/U, A-Grade satin walnut	20		037084310640	\$499
<b>GRAND</b>			<b>2¾" and 3" (screw-in chokes)</b>			
31675	30"	Single Barrel Trap Gun	12		037084316758	\$679
<b>UPLANDER (DT-EXT)</b>			<b>2¾" and 3" (screw-in chokes)</b>			
31140	26"	SxS, A-Grade satin walnut	12		037084311401	\$499
31145	28"	SxS, A-Grade satin walnut	12		037084311456	\$499
31150	26"	SxS, A-Grade satin walnut	20		037084311500	\$499
31190	26"	SxS, A-Grade satin walnut (2¾" only)	28	(fixed IC & M)	037084311906	\$499
31195	26"	SxS, A-Grade satin walnut	.410	(fixed F & F)	037084311951	\$499
<b>UPLANDER COMPACT (DT-EXT)</b>			<b>2¾" and 3"</b>			
31135	22"	SxS, A-Grade satin walnut, Short stock	.410	(fixed F & F)	037084311357	\$499
<b>UPLANDER SUPREME (ST-EXT)</b>			<b>2¾" and 3" (screw-in chokes)</b>			
31105	28"	SxS, AA-Grade gloss walnut	12		037084311050	\$599
<b>UPLANDER LONGFOWLER</b>			<b>2¾" and 3" (ext. screw-in chokes)</b>			
31062	30"	SxS, A-Grade satin walnut	12		037084310626	\$499

PRICE LIST

Item Number	Barrel Length	Description	Gauge / Caliber	Magazine Capacity	UPC Code	MSRP
<b>DOUBLE DEFENSE (ST-EXT)</b>			<b>2<sup>3</sup>/<sub>4</sub>" and 3" (fixed chokes)</b>			
31446	20"	SxS, Black synthetic	12	(fixed IC)	037084314464	\$529
31447	20"	SxS, Black finished walnut	20	(fixed IC)	037084314471	\$529
31089	20"	O/U, Black synthetic	12	(fixed IC)	037084310893	\$499
31088	20"	O/U, Black finished walnut	20	(fixed IC)	037084310886	\$499
<b>COACH GUN SUPREME (DT-EXT)</b>			<b>2<sup>3</sup>/<sub>4</sub>" and 3" (screw-in chokes)</b>			
31481	20"	SxS, AA-Grade gloss walnut, blue	12		037084314815	\$599
31483	20"	SxS, AA-Grade gloss walnut, blue/stainless receiver	12		037084314839	\$599
31482	20"	SxS, AA-Grade gloss walnut, Polished nickel	12		037084314822	\$599
31489	20"	SxS, AA-Grade gloss walnut, Polished nickel	20		037084314891	\$599
<b>COACH GUN SUPREME (ST-EXT)</b>			<b>2<sup>3</sup>/<sub>4</sub>" and 3" (screw-in chokes)</b>			
31463	20"	SxS, AA-Grade gloss walnut, blue/stainless receiver	12		037084314631	\$599
31462	20"	SxS, AA-Grade gloss walnut, blue/stainless receiver	20		037084314624	\$599
<b>COACH GUN (DT-EXT)</b>			<b>2<sup>3</sup>/<sub>4</sub>" and 3" (fixed chokes)</b>			
31400	20"	SxS, A-Grade satin walnut, blue	12	(fixed IC & M)	037084314006	\$499
31405	20"	SxS, A-Grade satin walnut, blue	20	(fixed IC & M)	037084314051	\$499
31410	20"	SxS, A-Grade satin walnut, blue	.410	(fixed F & F)	037084314105	\$499
31415	20"	SxS, Black walnut, Polished nickel	12	(fixed IC & M)	037084314150	\$599
<b>COACH GUN (ST-EXT)</b>			<b>2<sup>3</sup>/<sub>4</sub>" and 3" (fixed chokes)</b>			
31460	20"	SxS, A-Grade satin walnut, blue	12	(fixed IC & M)	037084314600	\$499
31461	20"	SxS, A-Grade satin walnut, blue	20	(fixed IC & M)	037084314617	\$499

AE = Automatic Ejector EXT = Extractor ST = Single Trigger DT = Double Trigger SST = Single Selective Trigger  
 This program supersedes all previously issued programs. Price in effect is price at time of shipment.

Item Number	Barrel Length	Description	Gauge / Caliber	Magazine Capacity	UPC Code	MSRP
<b>ACCESSORY ITEMS</b>						
<b>ACCESSORIES FOR STR-9</b>						
34059		Magazine 10-round	9 mm		037084340593	\$35
34057		Magazine 15-round	9 mm		037084340579	\$35
34058		Compact Magazine 13-round - Pinky Extension	9 mm		037084340586	\$35
34060		Compact Magazine 10-round - Pinky Extension	9 mm		037084340609	\$35
34090		Compact Magazine 13-round - Flush	9 mm		037084340906	\$35
34091		Compact Magazine 10-round - Flush	9 mm		037084340913	\$35
34055		Magazine Loading Tool	9 mm		037084340555	\$6
34036		Tritium Sight, Front			037084340364	\$50
34033		Tritium Sight, Rear			037084340333	\$70
34056		Kydex Holster, Right-hand			037084340562	\$50
<b>ACCESSORIES (fits Model 3500 and M3000)</b>						
33433		Bolt Handle (Fits M3000 & M3500)			037084334332	\$35
33480		Shim Kit (Fits M3000 & M3500)			037084334806	\$20
33567		Magazine Limiter Plug for M3000			037084335674	\$9
33492		Magazine Limiter Plug for M3500			037084334929	\$10
33488		Recoil Pad (Fits M3000 & M3500)			037084334882	\$19
33546		M3000/M3500 Magazine Cap Assembly Black			037084335469	\$50
33547		M3000/M3500 Magazine Cap Assembly Max4			037084335476	\$60
33548		M3000/M3500 Magazine Cap Assembly APG			037084335483	\$60
33454		M3500 Magazine Cap Black (Obs use 33546)			037084334547	\$55
33455		M3500 Magazine Cap Max4 (Obs use 33547)			037084334554	\$60
33456		M3500 Magazine Cap APG (Obs use 33548)			037084334561	\$60
<b>RECOIL REDUCER (fits M3000 / M3500)</b>						
33490		M3000/M3500 Recoil Reducer			037084334905	\$60
<b>ACCESSORIES (fits Model 2000)</b>						
33096		Bolt Handle, Chrome (Fits M2000)			037084330969	\$35
33151		Bolt Handle, Black (Fits M2000)			037084331515	\$35

*This program supersedes all previously issued programs. Price in effect is price at time of shipment.*

PRICE LIST

Item Number	Barrel Length	Description	Gauge / Caliber	Magazine Capacity	UPC Code	MSRP
<b>ACCESSORY ITEMS</b>						
<b>BARRELS FOR MODEL 3500</b>						
33434	28"	M3500 Matte Black	12		037084334349	\$189
33435	26"	M3500 Matte Black	12		037084334356	\$189
33436	24"	M3500 Matte Black	12		037084334363	\$189
33437	28"	M3500 Realtree® Max-4™	12		037084334370	\$229
33438	26"	M3500 Realtree® Max-4™	12		037084334387	\$229
33439	24"	M3500 Realtree® Max-4™	12		037084334394	\$229
33440	28"	M3500 Realtree® APG™	12		037084334400	\$229
33441	26"	M3500 Realtree® APG™	12		037084334417	\$229
33442	24"	M3500 Realtree® APG™	12		037084334424	\$229
<b>STOCKS AND FORE-ENDS (fits M3000 / M3500)</b>						
33390		SteadyGrip™ stock - Black synthetic – Fits ONLY M3000 & M3500			037084333908	\$89
33391		SteadyGrip™ stock - Realtree® APG™ – Fits ONLY M3000 & M3500			037084333915	\$109
33392		SteadyGrip™ stock - Realtree® Max-4™ – Fits ONLY M3000 & M3500			037084333922	\$109
33448		M3500 - Black synthetic fore-end			037084334486	\$69
33449		M3500 - Realtree® Max-4™ fore-end			037084334493	\$80
33450		M3500 - Realtree® APG™ fore-end			037084334509	\$80
33560		M3000 & M3500 - Black synthetic stock			037084335605	\$60
33561		M3000 & M3500 - Realtree® Max-4™ stock			037084335612	\$70
33562		M3000 & M3500 - Realtree® APG™ stock			037084335629	\$70
<b>CHOKE TUBES (fits P3500 / M2000 / M3000 / M3500)</b>						
33067	F	Choke Tube	12		037084330679	\$35
33068	IM	Choke Tube	12		037084330686	\$35
33069	M	Choke Tube	12		037084330693	\$35
33070	IC	Choke Tube	12		037084330709	\$35
33071	C	Choke Tube	12		037084330716	\$35
33212	XFT	Extended Extra-Full Turkey Choke Tube	12		037084332123	\$35
33064		Mobil Choke Key	12/20		037084330648	\$10
<b>EXTENDED CHOKE TUBES (fits SxS &amp; O/U &amp; SB)</b>						
39192	C	Choke Tube Extended	12		037084391922	\$50
39193	IC	Choke Tube Extended	12		037084391939	\$50
39194	M	Choke Tube Extended	12		037084391946	\$50
39195	IM	Choke Tube Extended	12		037084391953	\$50
39196	F	Choke Tube Extended	12		037084391960	\$50
39197	C	Choke Tube Extended	20		037084391977	\$50
39198	IC	Choke Tube Extended	20		037084391984	\$50
39199	M	Choke Tube Extended	20		037084391991	\$50
39200	IM	Choke Tube Extended	20		037084392004	\$50
39201	F	Choke Tube Extended	20		037084392011	\$50

*This program supersedes all previously issued programs. Price in effect is price at time of shipment.*

Item Number	Description	Color	Size	UPC Code	MSRP
<b>ACCESSORY ITEMS AND LOGO APPAREL</b>					
<b>CHOKE TUBES (fits SxS &amp; O/U &amp; SB)</b>					
33200	F	Choke Tube	12	0037084332000	\$35
33201	IM	Choke Tube	12	0037084332017	\$35
33202	M	Choke Tube	12	0037084332024	\$35
33203	IC	Choke Tube	12	0037084332031	\$35
33204	C	Choke Tube	12	0037084332048	\$35
33205	F	Choke Tube	20	0037084332055	\$35
33206	IM	Choke Tube	20	0037084332062	\$35
33207	M	Choke Tube	20	0037084332079	\$35
33208	IC	Choke Tube	20	0037084332086	\$35
33209	C	Choke Tube	20	0037084332093	\$35
33210		Choke Wrench	12	0037084332109	\$35
33211		Choke Wrench	20	0037084332116	\$35
<b>GUN CASES AND SLINGS</b>					
94210	Stoeger Soft Shotgun Case	Black	52"	037084942100	\$35
94201	Stoeger Floater Soft Shotgun Case	Realtree® Max-7™	52"	037084942018	\$45
94205	Stoeger Floater Soft Shotgun Case	Mossy Oak® Bottomland™	52"	037084942056	\$45
94215	STR-9 Case / Range Bag	Black		037084942155	\$30
<b>EMBROIDERED HATS</b>					
91258	Stoeger Logo Hat	Faded Black & Gray Mesh		037084912585	\$25
91259	Stoeger Logo Hat	Realtree® Max-7 & Khaki Mesh		037084912592	\$25
91251	Stoeger Logo Hat	Blaze Orange		037084912516	\$25
91253	Stoeger Vintage Hat	Faded Blue & Sand Mesh		037084912530	\$25
91257	Stoeger Patch Vintage Hat	Marsh & Brown Mesh		037084912578	\$25
91260	Stoeger Trucker Hat	Mossy Oak® Bottomland™ & Khaki Mesh		037084912608	\$25
91256	Stoeger Logo Patch Hat	Vintage Marsh & Brown Mesh		037084912561	\$25
<b>STOEGER LOGO T-SHIRT</b>					
95200S	Stoeger Logo T-shirt	Charcoal	Small	037084962375	\$25
95200M	Stoeger Logo T-shirt	Charcoal	Medium	037084962382	\$25
95200L	Stoeger Logo T-shirt	Charcoal	Large	037084962399	\$25
95200XL	Stoeger Logo T-shirt	Charcoal	X-Large	037084962405	\$25
95200XXL	Stoeger Logo T-shirt	Charcoal	XX-Large	037084962412	\$25
<b>STOEGER FREEDOM SERIES T-SHIRT</b>					
95201S	Stoeger Freedom Series T-shirt	Oxford	Small	037084964430	\$25
95201M	Stoeger Freedom Series T-shirt	Oxford	Medium	037084964447	\$25
95201L	Stoeger Freedom Series T-shirt	Oxford	Large	037084964454	\$25
95201XL	Stoeger Freedom Series T-shirt	Oxford	X-Large	037084964461	\$25
95201XXL	Stoeger Freedom Series T-shirt	Oxford	XX-Large	037084964478	\$25

*This program supersedes all previously issued programs. Price in effect is price at time of shipment.*

PRICE LIST

Item Number	Description	Color	Size	UPC Code	MSRP
-------------	-------------	-------	------	----------	------

**LOGO APPAREL AND ACCESSORIES**

**STOEGER HEAVYWEIGHT HOODED LOGO SWEATSHIRT**

95250S	Stoeger Vintage Logo Heavyweight	Dark Gray	Small	037084964485	\$70
95250M	Stoeger Vintage Logo Heavyweight	Dark Gray	Medium	037084964492	\$70
95250L	Stoeger Vintage Logo Heavyweight	Dark Gray	Large	037084964508	\$70
95250XL	Stoeger Vintage Logo Heavyweight	Dark Gray	X-Large	037084964515	\$70
95250XXL	Stoeger Vintage Logo Heavyweight	Dark Gray	XX-Large	037084964522	\$70

**STOEGER VINTAGE LOGO T-SHIRT**

<b>NEW</b> 95202S	Stoeger Vintage Logo Tee	Olive	Small	037084968605	\$30
<b>NEW</b> 95202M	Stoeger Vintage Logo Tee	Olive	Medium	037084968612	\$30
<b>NEW</b> 95202L	Stoeger Vintage Logo Tee	Olive	Large	037084968629	\$30
<b>NEW</b> 95202XL	Stoeger Vintage Logo Tee	Olive	X-Large	037084968636	\$30
<b>NEW</b> 95202XXL	Stoeger Vintage Logo Tee	Olive	XX-Large	037084968643	\$30
<b>NEW</b> 95202XXXL	Stoeger Vintage Logo Tee	Olive	XXX-Large	037084968650	\$30

**STOEGER GAME SHIELD T-SHIRT**

<b>NEW</b> 95203S	Stoeger Game Shield Tee	Black	Small	037084968667	\$30
<b>NEW</b> 95203M	Stoeger Game Shield Tee	Black	Medium	037084968674	\$30
<b>NEW</b> 95203L	Stoeger Game Shield Tee	Black	Large	037084968681	\$30
<b>NEW</b> 95203XL	Stoeger Game Shield Tee	Black	X-Large	037084968698	\$30
<b>NEW</b> 95203XXL	Stoeger Game Shield Tee	Black	XX-Large	037084968704	\$30
<b>NEW</b> 95203XXXL	Stoeger Game Shield Tee	Black	XXX-Large	037084968711	\$30

*This program supersedes all previously issued programs. Price in effect is price at time of shipment.*



For Sales, Customer Service, Accounting and Marketing contact: Stoeger Industries  
 Phone: 800-264-4962 Fax: 301-283-6988 www.stoegerindustries.com Email: info@stoegerindustries.com  
**ONLY SHIP FIREARMS FOR WARRANTY REPAIR TO: Stoeger Industries, 901 Eighth Street, Pocomoke, MD 21851**  
**\*\* Return Authorization Required Prior to Shipment \*\***

